

| Elemento | Pos. | Diam. | No. | Esquema (cm) | Long. (cm) | Total B 500 S, Ys=1.15 (kg) | |
|------------|------------|-------|-----|--------------|------------|-----------------------------|------|
| Punto 1 | 1 | Ø10 | 2 | | 440 800 | 4.4 | |
| | 2 | Ø10 | 2 | | 865 1730 | 15.7 | |
| | 3 | Ø10 | 2 | | 900 900 | 5.5 | |
| | 4 | Ø10 | 2 | | 865 1710 | 15.5 | |
| | 5 | Ø8 | 70 | | 70 8004 | 13.3 | |
| Total (kg) | | | | | | | 48.8 |
| Punto 2 | 1 | Ø10 | 2 | | 990 200 | 3.7 | |
| | 2 | Ø10 | 2 | | 206 410 | 2.6 | |
| | 3 | Ø8 | 5 | | 70 360 | 5.8 | |
| Total (kg) | | | | | | | 12.1 |
| Punto 3 | 1 | Ø10 | 2 | | 362 720 | 5.0 | |
| | 2 | Ø10 | 2 | | 360 720 | 4.7 | |
| | 3 | Ø8 | 55 | | 70 1620 | 5.7 | |
| Total (kg) | | | | | | | 15.4 |
| Punto 4 | 1 | Ø10 | 2 | | 464 920 | 5.0 | |
| | 2 | Ø10 | 2 | | 602 1004 | 6.2 | |
| | 3 | Ø8 | 35 | | 70 2004 | 4.8 | |
| Total (kg) | | | | | | | 16.0 |
| Punto 5 | 1 | Ø10 | 4 | | 600 804 | 10.7 | |
| | 2 | Ø8 | 15 | | 60 4650 | 14.3 | |
| Total (kg) | | | | | | | 25.0 |
| Punto 6 | 1 | Ø10 | 2 | | 610 1220 | 16.3 | |
| | 2 | Ø10 | 2 | | 610 1220 | 16.8 | |
| | 3 | Ø8 | 45 | | 60 3614 | 6.0 | |
| Total (kg) | | | | | | | 49.1 |
| Punto 7 | 1 | Ø10 | 2 | | 207 410 | 6.4 | |
| | 2 | Ø10 | 2 | | 200 566 | 5.0 | |
| | 3 | Ø8 | 15 | | 60 1200 | 3.8 | |
| Total (kg) | | | | | | | 15.2 |
| Punto 8 | 1 | Ø10 | 2 | | 200 404 | 3.6 | |
| | 2 | Ø10 | 2 | | 300 600 | 4.1 | |
| | 3 | Ø8 | 15 | | 70 1356 | 3.0 | |
| Total (kg) | | | | | | | 10.7 |
| Punto 9 | 1 | Ø10 | 2 | | 310 620 | 3.9 | |
| | 2 | Ø10 | 2 | | 310 620 | 4.3 | |
| | 3 | Ø8 | 10 | | 70 1444 | 3.2 | |
| Total (kg) | | | | | | | 11.4 |
| Punto 10 | 1 | Ø10 | 4 | | 731 2004 | 48.2 | |
| | 2 | Ø10 | 3 | | 166 166 | 3.8 | |
| | 3 | Ø10 | 1 | | 100 100 | 2.8 | |
| | 4 | Ø8 | 67 | | 60 6702 | 12.8 | |
| Total (kg) | | | | | | | 73.6 |
| Punto 11 | 1 | Ø10 | 2 | | 100 200 | 1.4 | |
| | 2 | Ø10 | 1 | | 160 160 | 3.5 | |
| | 3 | Ø10 | 1 | | 160 160 | 3.5 | |
| | 4 | Ø8 | 65 | | 60 6074 | 12.6 | |
| Total (kg) | | | | | | | 43.0 |
| Punto 12 | 1 | Ø10 | 3 | | 176 528 | 12.9 | |
| | 2 | Ø10 | 2 | | 170 378 | 3.0 | |
| | 3 | Ø8 | 10 | | 60 660 | 3.0 | |
| Total (kg) | | | | | | | 18.9 |
| Punto 13 | 1 | Ø10 | 2 | | 300 600 | 3.9 | |
| | 2 | Ø10 | 2 | | 60 1612 | 3.0 | |
| | 3 | Ø8 | 51 | | 70 3074 | 6.6 | |
| Total (kg) | | | | | | | 13.5 |
| Punto 14 | 1 | Ø10 | 2 | | 194 388 | 2.4 | |
| | 2 | Ø10 | 2 | | 208 416 | 2.9 | |
| | 3 | Ø8 | 12 | | 70 912 | 2.0 | |
| Total (kg) | | | | | | | 7.3 |
| Punto 15 | 1 | Ø10 | 2 | | 300 600 | 3.9 | |
| | 2 | Ø10 | 2 | | 304 1860 | 13.6 | |
| | 3 | Ø8 | 68 | | 70 4402 | 10.0 | |
| Total (kg) | | | | | | | 27.5 |
| Punto 16 | 1 | Ø10 | 2 | | 737 1474 | 16.1 | |
| | 2 | Ø10 | 2 | | 736 1474 | 16.4 | |
| | 3 | Ø10 | 1 | | 316 316 | 3.4 | |
| | 4 | Ø10 | 1 | | 165 165 | 1.5 | |
| | 5 | Ø10 | 1 | | 60 60 | 0.6 | |
| Total (kg) | | | | | | | 48.0 |
| Punto 17 | 1 | Ø10 | 2 | | 170 340 | 2.3 | |
| | 2 | Ø10 | 2 | | 170 340 | 2.3 | |
| | 3 | Ø10 | 1 | | 170 340 | 2.3 | |
| | 4 | Ø10 | 1 | | 170 340 | 2.3 | |
| | 5 | Ø10 | 1 | | 170 340 | 2.3 | |
| | 6 | Ø8 | 72 | | 60 6042 | 11.7 | |
| Total (kg) | | | | | | | 16.2 |
| Punto 18 | 1 | Ø10 | 2 | | 60 138 | 0.9 | |
| | 2 | Ø10 | 2 | | 60 276 | 1.8 | |
| | 3 | Ø8 | 6 | | 70 606 | 1.3 | |
| Total (kg) | | | | | | | 4.0 |
| Punto 19 | 1 | Ø10 | 2 | | 207 410 | 3.0 | |
| | 2 | Ø10 | 2 | | 207 410 | 3.0 | |
| | 3 | Ø8 | 15 | | 60 660 | 3.0 | |
| Total (kg) | | | | | | | 9.0 |
| Punto 20 | 1 | Ø10 | 2 | | 255 510 | 3.0 | |
| | 2 | Ø10 | 2 | | 240 480 | 3.0 | |
| | 3 | Ø8 | 32 | | 60 1660 | 4.2 | |
| Total (kg) | | | | | | | 10.2 |
| Punto 21 | 1 | Ø10 | 2 | | 375 750 | 5.0 | |
| | 2 | Ø10 | 2 | | 374 748 | 5.0 | |
| | 3 | Ø8 | 35 | | 60 800 | 3.4 | |
| Total (kg) | | | | | | | 13.4 |
| Punto 22 | 1 | Ø10 | 4 | | 144 432 | 5.8 | |
| | 2 | Ø8 | 15 | | 70 1140 | 2.0 | |
| Total (kg) | | | | | | | 7.8 |
| Punto 23 | 1 | Ø10 | 4 | | 134 402 | 5.3 | |
| | 2 | Ø8 | 7 | | 70 630 | 1.2 | |
| Total (kg) | | | | | | | 6.5 |
| Punto 24 | 1 | Ø10 | 4 | | 50 200 | 1.6 | |
| | 2 | Ø8 | 35 | | 70 2000 | 5.0 | |
| | Total (kg) | | | | | | |
| Punto 25 | 1 | Ø10 | 2 | | 115 230 | 1.4 | |
| | 2 | Ø10 | 2 | | 114 228 | 1.4 | |
| | 3 | Ø8 | 5 | | 70 350 | 0.8 | |
| Total (kg) | | | | | | | 3.6 |

| Elemento | Pos. | Diam. | No. | Esquema (cm) | Long. (cm) | Total B 500 S, Ys=1.15 (kg) | |
|------------|------|-------|-----|--------------|------------|-----------------------------|------|
| Punto 26 | 1 | Ø10 | 2 | | 60 170 | 1.3 | |
| | 2 | Ø10 | 2 | | 107 214 | 1.5 | |
| Punto 27 | 1 | Ø10 | 4 | | 144 566 | 3.5 | |
| | 2 | Ø8 | 6 | | 70 606 | 1.3 | |
| Total (kg) | | | | | | | 6.3 |
| Punto 28 | 1 | Ø10 | 2 | | 600 1200 | 14.0 | |
| | 2 | Ø10 | 2 | | 630 1260 | 14.9 | |
| | 3 | Ø10 | 1 | | 200 200 | 4.4 | |
| | 4 | Ø10 | 1 | | 460 460 | 4.4 | |
| | 5 | Ø8 | 55 | | 60 510 | 5.0 | |
| Total (kg) | | | | | | | 36.7 |
| Punto 29 | 1 | Ø10 | 2 | | 641 1282 | 16.5 | |
| | 2 | Ø10 | 2 | | 640 1280 | 16.9 | |
| | 3 | Ø10 | 1 | | 195 195 | 3.1 | |
| | 4 | Ø10 | 1 | | 200 200 | 3.8 | |
| | 5 | Ø8 | 55 | | 60 640 | 5.0 | |
| Total (kg) | | | | | | | 45.3 |

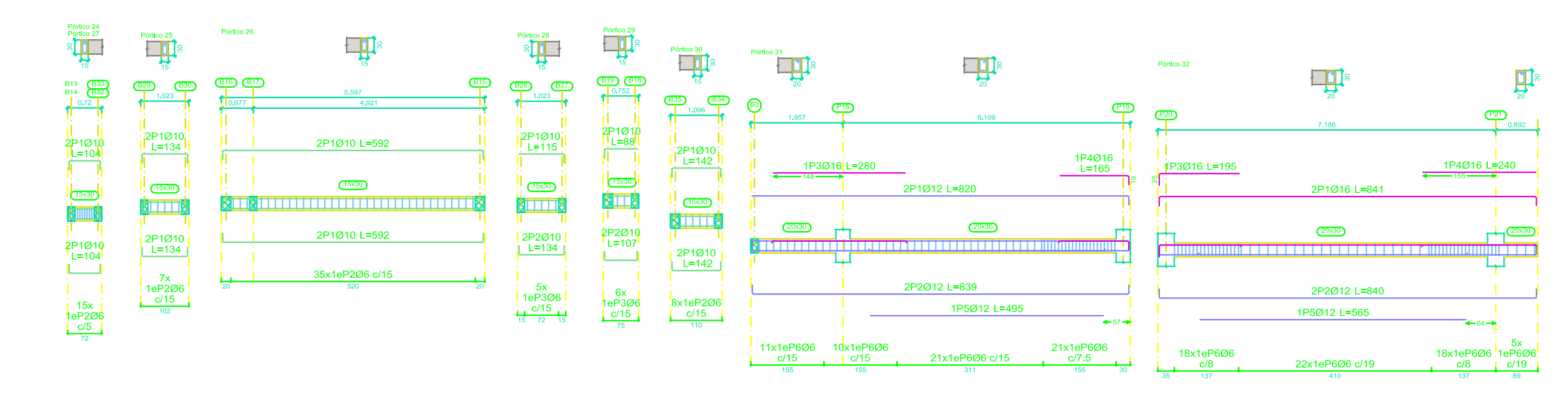
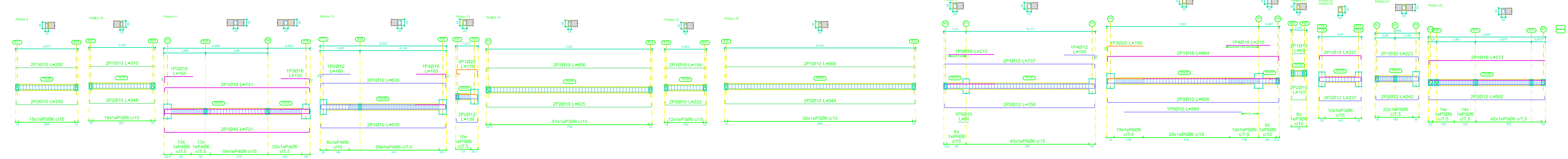
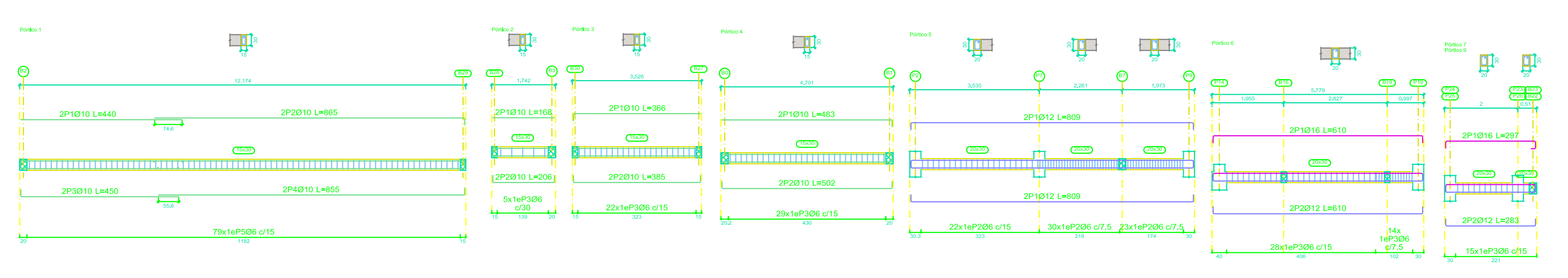

| Resumen Acero | Long. total (m) | Peso 10% (kg) | Total |
|------------------|-----------------|---------------|-------|
| B 500 S, Ys=1.15 | 606 | 654.2 | 209 |
| Ø10 | 254.1 | 172 | |
| Ø12 | 231.1 | 228 | |
| Ø16 | 326.2 | 219 | |
| Ø20 | 7.2 | 20 | 846 |

Planta 4
 Despliegue de vigas
 Hormigón: HA-25, Yc=1.5
 Acero en estribos: B 500 S, Ys=1.15
 Escala pòrticos 1:100
 Escala secciones 1:100
 Escala huecos 1:100

UNIVERSIDAD AUTONOMA "JUAN MISAEL SARACHO"
FACULTAD DE CIENCIAS Y TECNOLOGIA

PROYECTO:
DISEÑO ESTRUCTURAL DEL EDIFICIO PARA DEPARTAMENTOS EN EL BARRIO LAS PANOSAS

| | |
|---|--|
| CARACTER : DESIECE DE VIGAS DEL PISO 4 | DOCENTE : ING. CARRASCO ARNOLD PAUL DENNIS. |
| UNIVERSITARIO: HURTADO CACERES JOSUE | ESCALA: 1 : 100 |
| VoBo | GRUPO: IV |
| FECHA: JULIO DE 2022 | LAMINA: 18/22 |

| Elemento | Pos. | Diam. | No. | Esquema (cm) | Long. Total (cm) | B 500 S, Ys=1.15 (kg) | |
|------------|------|-------|-----|--------------|------------------|-----------------------|------|
| Pórtico 1 | 1 | Ø10 | 2 | | 690 | 1300 | 8.7 |
| | 2 | Ø10 | 2 | | 690 | 1300 | 8.8 |
| | 3 | Ø10 | 2 | | 560 | 1120 | 6.9 |
| | 4 | Ø10 | 2 | | 560 | 1120 | 6.9 |
| | 5 | Ø10 | 2 | | 690 | 1300 | 8.7 |
| | 6 | Ø10 | 2 | | 690 | 1300 | 8.7 |
| | 7 | Ø6 | 127 | | 74 | 1440 | 21.4 |
| Pórtico 2 | 1 | Ø10 | 2 | | 230 | 470 | 2.9 |
| | 2 | Ø10 | 2 | | 230 | 470 | 2.9 |
| | 3 | Ø6 | 14 | | 74 | 1440 | 21.4 |
| Pórtico 3 | 1 | Ø12 | 4 | | 271 | 540 | 3.7 |
| | 2 | Ø6 | 14 | | 74 | 1440 | 21.4 |
| Pórtico 4 | 1 | Ø12 | 4 | | 666 | 1330 | 9.3 |
| | 2 | Ø12 | 4 | | 666 | 1330 | 9.3 |
| | 3 | Ø12 | 4 | | 150 | 300 | 1.9 |
| | 4 | Ø6 | 14 | | 74 | 1440 | 21.4 |
| Pórtico 5 | 1 | Ø10 | 2 | | 230 | 470 | 2.9 |
| | 2 | Ø10 | 2 | | 230 | 470 | 2.9 |
| | 3 | Ø6 | 14 | | 74 | 1440 | 21.4 |
| Pórtico 6 | 1 | Ø10 | 2 | | 230 | 470 | 2.9 |
| | 2 | Ø10 | 2 | | 230 | 470 | 2.9 |
| | 3 | Ø6 | 14 | | 74 | 1440 | 21.4 |
| Pórtico 7 | 1 | Ø10 | 2 | | 230 | 470 | 2.9 |
| | 2 | Ø10 | 2 | | 230 | 470 | 2.9 |
| | 3 | Ø6 | 14 | | 74 | 1440 | 21.4 |
| Pórtico 8 | 1 | Ø12 | 4 | | 666 | 1330 | 9.3 |
| | 2 | Ø12 | 4 | | 666 | 1330 | 9.3 |
| | 3 | Ø12 | 4 | | 150 | 300 | 1.9 |
| | 4 | Ø6 | 14 | | 74 | 1440 | 21.4 |
| Pórtico 9 | 1 | Ø10 | 2 | | 230 | 470 | 2.9 |
| | 2 | Ø10 | 2 | | 230 | 470 | 2.9 |
| | 3 | Ø6 | 14 | | 74 | 1440 | 21.4 |
| Pórtico 10 | 1 | Ø12 | 4 | | 666 | 1330 | 9.3 |
| | 2 | Ø12 | 4 | | 666 | 1330 | 9.3 |
| | 3 | Ø12 | 4 | | 150 | 300 | 1.9 |
| | 4 | Ø6 | 14 | | 74 | 1440 | 21.4 |
| Pórtico 11 | 1 | Ø10 | 2 | | 170 | 340 | 2.2 |
| | 2 | Ø12 | 2 | | 170 | 340 | 2.2 |
| | 3 | Ø16 | 2 | | 170 | 340 | 2.2 |
| | 4 | Ø6 | 14 | | 74 | 1440 | 21.4 |
| Pórtico 12 | 1 | Ø10 | 2 | | 230 | 470 | 2.9 |
| | 2 | Ø10 | 2 | | 230 | 470 | 2.9 |
| | 3 | Ø6 | 14 | | 74 | 1440 | 21.4 |
| Pórtico 13 | 1 | Ø10 | 2 | | 190 | 380 | 2.5 |
| | 2 | Ø10 | 2 | | 190 | 380 | 2.5 |
| | 3 | Ø6 | 14 | | 74 | 1440 | 21.4 |
| Pórtico 14 | 1 | Ø10 | 2 | | 230 | 470 | 2.9 |
| | 2 | Ø10 | 2 | | 230 | 470 | 2.9 |
| | 3 | Ø6 | 14 | | 74 | 1440 | 21.4 |
| Pórtico 15 | 1 | Ø10 | 2 | | 737 | 1470 | 9.9 |
| | 2 | Ø10 | 2 | | 737 | 1470 | 9.9 |
| | 3 | Ø10 | 2 | | 200 | 400 | 2.6 |
| | 4 | Ø6 | 14 | | 74 | 1440 | 21.4 |
| Pórtico 16 | 1 | Ø10 | 2 | | 480 | 960 | 6.3 |
| | 2 | Ø10 | 2 | | 480 | 960 | 6.3 |
| | 3 | Ø10 | 2 | | 480 | 960 | 6.3 |
| | 4 | Ø6 | 14 | | 74 | 1440 | 21.4 |
| Pórtico 17 | 1 | Ø16 | 2 | | 641 | 1280 | 8.6 |
| | 2 | Ø12 | 2 | | 641 | 1280 | 8.6 |
| | 3 | Ø10 | 2 | | 150 | 300 | 1.9 |
| Pórtico 18 | 1 | Ø12 | 4 | | 666 | 1330 | 9.3 |
| | 2 | Ø12 | 4 | | 666 | 1330 | 9.3 |
| | 3 | Ø12 | 4 | | 150 | 300 | 1.9 |
| | 4 | Ø6 | 14 | | 74 | 1440 | 21.4 |
| Pórtico 19 | 1 | Ø10 | 2 | | 230 | 470 | 2.9 |
| | 2 | Ø10 | 2 | | 230 | 470 | 2.9 |
| | 3 | Ø6 | 14 | | 74 | 1440 | 21.4 |
| Pórtico 20 | 1 | Ø16 | 2 | | 841 | 1680 | 11.6 |
| | 2 | Ø12 | 2 | | 841 | 1680 | 11.6 |
| | 3 | Ø10 | 2 | | 150 | 300 | 1.9 |
| | 4 | Ø6 | 14 | | 74 | 1440 | 21.4 |
| Pórtico 21 | 1 | Ø12 | 4 | | 237 | 470 | 3.2 |
| | 2 | Ø12 | 4 | | 237 | 470 | 3.2 |
| | 3 | Ø6 | 14 | | 74 | 1440 | 21.4 |
| Pórtico 22 | 1 | Ø12 | 4 | | 666 | 1330 | 9.3 |
| | 2 | Ø12 | 4 | | 666 | 1330 | 9.3 |
| | 3 | Ø12 | 4 | | 150 | 300 | 1.9 |
| | 4 | Ø6 | 14 | | 74 | 1440 | 21.4 |
| Pórtico 23 | 1 | Ø10 | 2 | | 230 | 470 | 2.9 |
| | 2 | Ø10 | 2 | | 230 | 470 | 2.9 |
| | 3 | Ø6 | 14 | | 74 | 1440 | 21.4 |
| Pórtico 24 | 1 | Ø10 | 2 | | 170 | 340 | 2.2 |
| | 2 | Ø10 | 2 | | 170 | 340 | 2.2 |
| | 3 | Ø6 | 14 | | 74 | 1440 | 21.4 |
| Pórtico 25 | 1 | Ø10 | 4 | | 107 | 210 | 1.4 |
| | 2 | Ø6 | 14 | | 74 | 1440 | 21.4 |

| Elemento | Pos. | Diam. | No. | Esquema (cm) | Long. Total (cm) | B 500 S, Ys=1.15 (kg) | |
|------------|------|-------|-----|--------------|------------------|-----------------------|------|
| Pórtico 26 | 1 | Ø12 | 2 | | 600 | 1200 | 8.1 |
| | 2 | Ø12 | 2 | | 600 | 1200 | 8.1 |
| | 3 | Ø12 | 2 | | 285 | 570 | 3.8 |
| | 4 | Ø12 | 2 | | 285 | 570 | 3.8 |
| Pórtico 27 | 1 | Ø10 | 4 | | 141 | 280 | 1.9 |
| | 2 | Ø6 | 14 | | 74 | 1440 | 21.4 |
| Pórtico 28 | 1 | Ø16 | 4 | | 640 | 1280 | 8.6 |
| | 2 | Ø12 | 4 | | 640 | 1280 | 8.6 |
| | 3 | Ø10 | 4 | | 150 | 300 | 1.9 |
| | 4 | Ø6 | 14 | | 74 | 1440 | 21.4 |

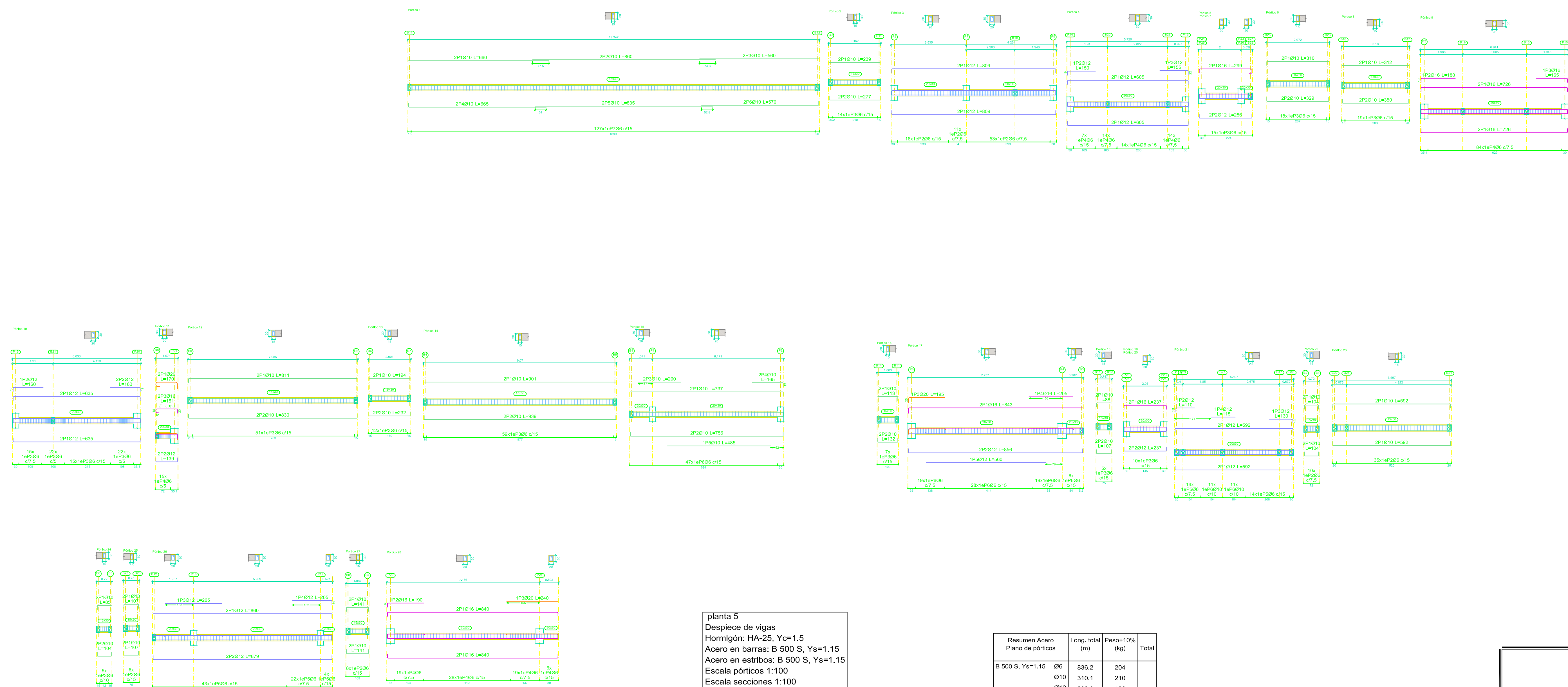

planta 5
Despiece de vigas
Hormigón: HA-25, Yc=1.5
Acero en barras: B 500 S, Ys=1.15
Acero en estribos: B 500 S, Ys=1.15
Escala pórticos 1:100
Escala secciones 1:100

| Resumen Acero | Long. total (m) | Peso+10% (kg) | Total |
|------------------|-----------------|---------------|-------|
| B 500 S, Ys=1.15 | 638.2 | 204 | |
| Ø10 | 310.1 | 210 | |
| Ø12 | 202.9 | 198 | |
| Ø16 | 111.4 | 193 | |
| Ø20 | 7.8 | 21 | 826 |



**UNIVERSIDAD AUTONOMA
"JUAN MISAEL SARACHO"
FACULTAD DE CIENCIAS Y
TECNOLOGIA**

PROYECTO :
**DISEÑO ESTRUCTURAL DEL EDIFICIO
PARA DEPARTAMENTOS EN EL BARRIO
LAS PANOSAS**

| | |
|--|---|
| CARACTER : DESIECE DE VIGAS DEL PISO 5 | DOCENTE : ING. CARRASCO ARNOLD PAUL DENNIS. |
|--|---|

| | | |
|--|--------------------|-------------------------|
| UNIVERSITARIO: HURTADO CACERES JOSUE | ESCALA: 1 : 100 | LAMINA: 19/22 |
|--|--------------------|-------------------------|

| | | | |
|------|-----------|----------------------|--|
| VoBo | GRUPO: IV | FECHA: JULIO DE 2022 | |
|------|-----------|----------------------|--|

| Elemento | Pos. | Diam. | No. | Long. Total (cm) | Peso (kg) |
|---------------------|------|-------|-----|------------------|-----------|
| Escalera S Tramo 1 | 11 | Ø10 | 7 | 2017 | 20,7 |
| | 12 | Ø10 | 7 | 2017 | 20,7 |
| | 13 | Ø10 | 7 | 2017 | 20,7 |
| | 14 | Ø10 | 7 | 2017 | 20,7 |
| | 15 | Ø10 | 7 | 2017 | 20,7 |
| | 16 | Ø10 | 7 | 2017 | 20,7 |
| | 17 | Ø10 | 7 | 2017 | 20,7 |
| | 18 | Ø10 | 7 | 2017 | 20,7 |
| | 19 | Ø10 | 7 | 2017 | 20,7 |
| | 20 | Ø10 | 7 | 2017 | 20,7 |
| Escalera PB Tramo 1 | 08 | Ø8 | 7 | 2017 | 10,4 |
| | 09 | Ø8 | 7 | 2017 | 10,4 |
| | 10 | Ø8 | 7 | 2017 | 10,4 |
| | 11 | Ø8 | 7 | 2017 | 10,4 |
| | 12 | Ø8 | 7 | 2017 | 10,4 |
| | 13 | Ø8 | 7 | 2017 | 10,4 |
| | 14 | Ø8 | 7 | 2017 | 10,4 |
| | 15 | Ø8 | 7 | 2017 | 10,4 |
| | 16 | Ø8 | 7 | 2017 | 10,4 |
| | 17 | Ø8 | 7 | 2017 | 10,4 |
| Escalera M Tramo 1 | 08 | Ø8 | 7 | 2017 | 10,4 |
| | 09 | Ø8 | 7 | 2017 | 10,4 |
| | 10 | Ø8 | 7 | 2017 | 10,4 |
| | 11 | Ø8 | 7 | 2017 | 10,4 |
| | 12 | Ø8 | 7 | 2017 | 10,4 |
| | 13 | Ø8 | 7 | 2017 | 10,4 |
| | 14 | Ø8 | 7 | 2017 | 10,4 |
| | 15 | Ø8 | 7 | 2017 | 10,4 |
| | 16 | Ø8 | 7 | 2017 | 10,4 |
| | 17 | Ø8 | 7 | 2017 | 10,4 |
| Escalera M2 Tramo 1 | 08 | Ø8 | 7 | 2017 | 10,4 |
| | 09 | Ø8 | 7 | 2017 | 10,4 |
| | 10 | Ø8 | 7 | 2017 | 10,4 |
| | 11 | Ø8 | 7 | 2017 | 10,4 |
| | 12 | Ø8 | 7 | 2017 | 10,4 |
| | 13 | Ø8 | 7 | 2017 | 10,4 |
| | 14 | Ø8 | 7 | 2017 | 10,4 |
| | 15 | Ø8 | 7 | 2017 | 10,4 |
| | 16 | Ø8 | 7 | 2017 | 10,4 |
| | 17 | Ø8 | 7 | 2017 | 10,4 |

| Resumen Acero Escalera S | Long. total (m) | Peso+10% (kg) | Total |
|--------------------------|-----------------|---------------|-------|
| B 500 S, Y=1,15 Ø8 | 154,2 | 67 | 128 |
| Ø10 | 89,5 | 61 | 128 |

| Resumen Acero Escalera PB | Long. total (m) | Peso+10% (kg) | Total |
|---------------------------|-----------------|---------------|-------|
| B 500 S, Y=1,15 Ø8 | 78,1 | 34 | 184 |
| Ø10 | 86,5 | 59 | 184 |
| Ø12 | 93,1 | 91 | 184 |

| Resumen Acero Escalera M | Long. total (m) | Peso+10% (kg) | Total |
|--------------------------|-----------------|---------------|-------|
| B 500 S, Y=1,15 Ø8 | 248,0 | 109 | |

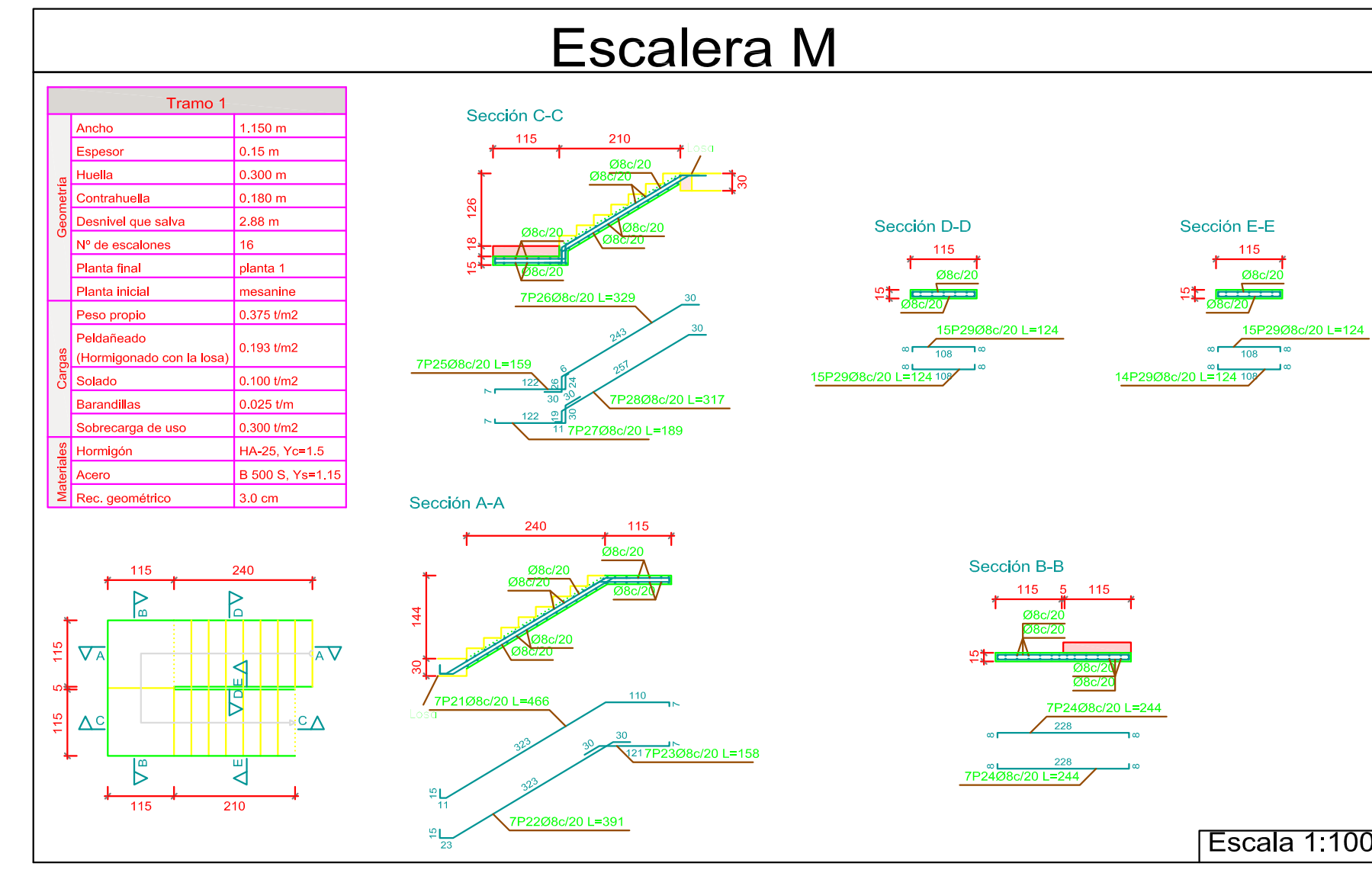
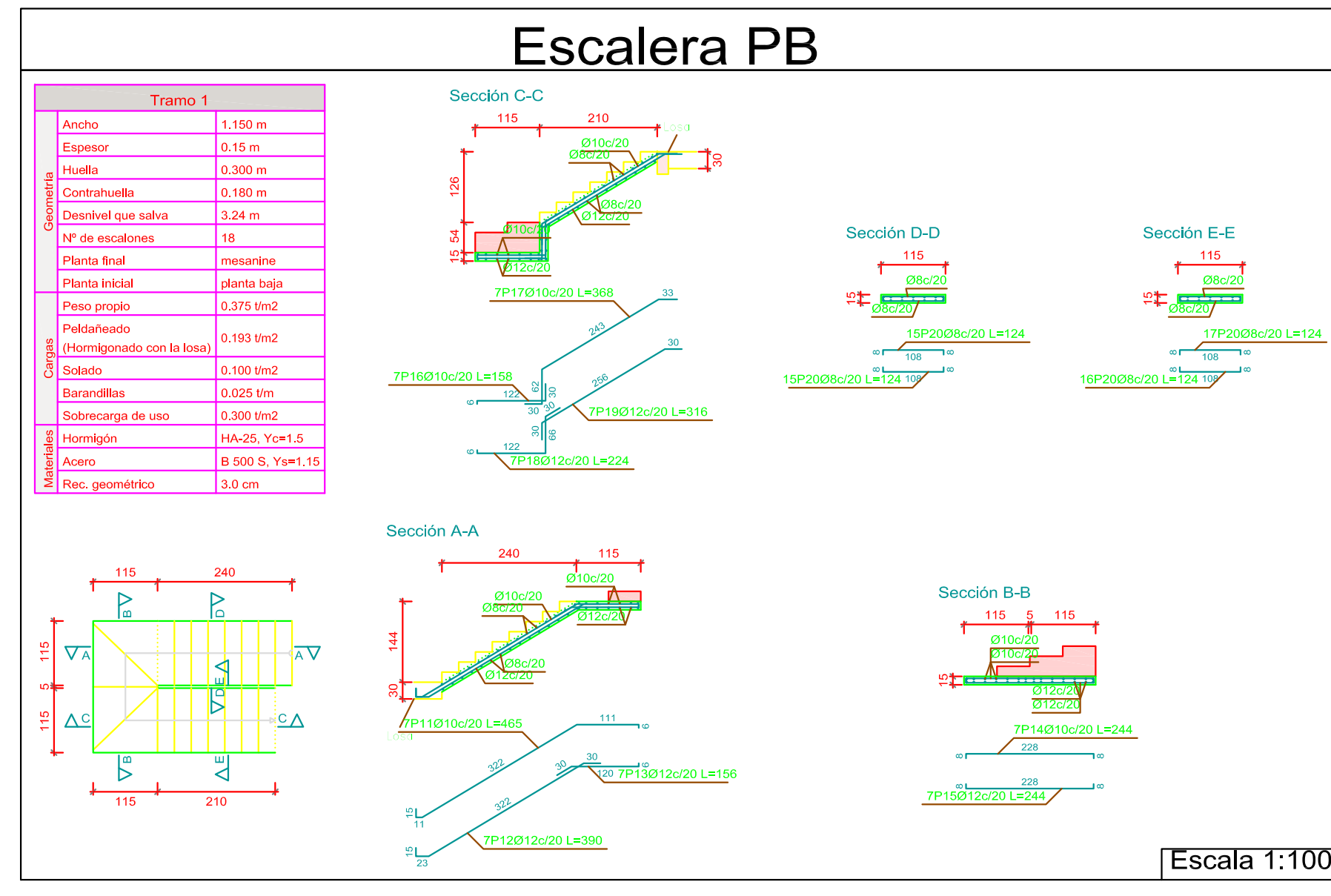
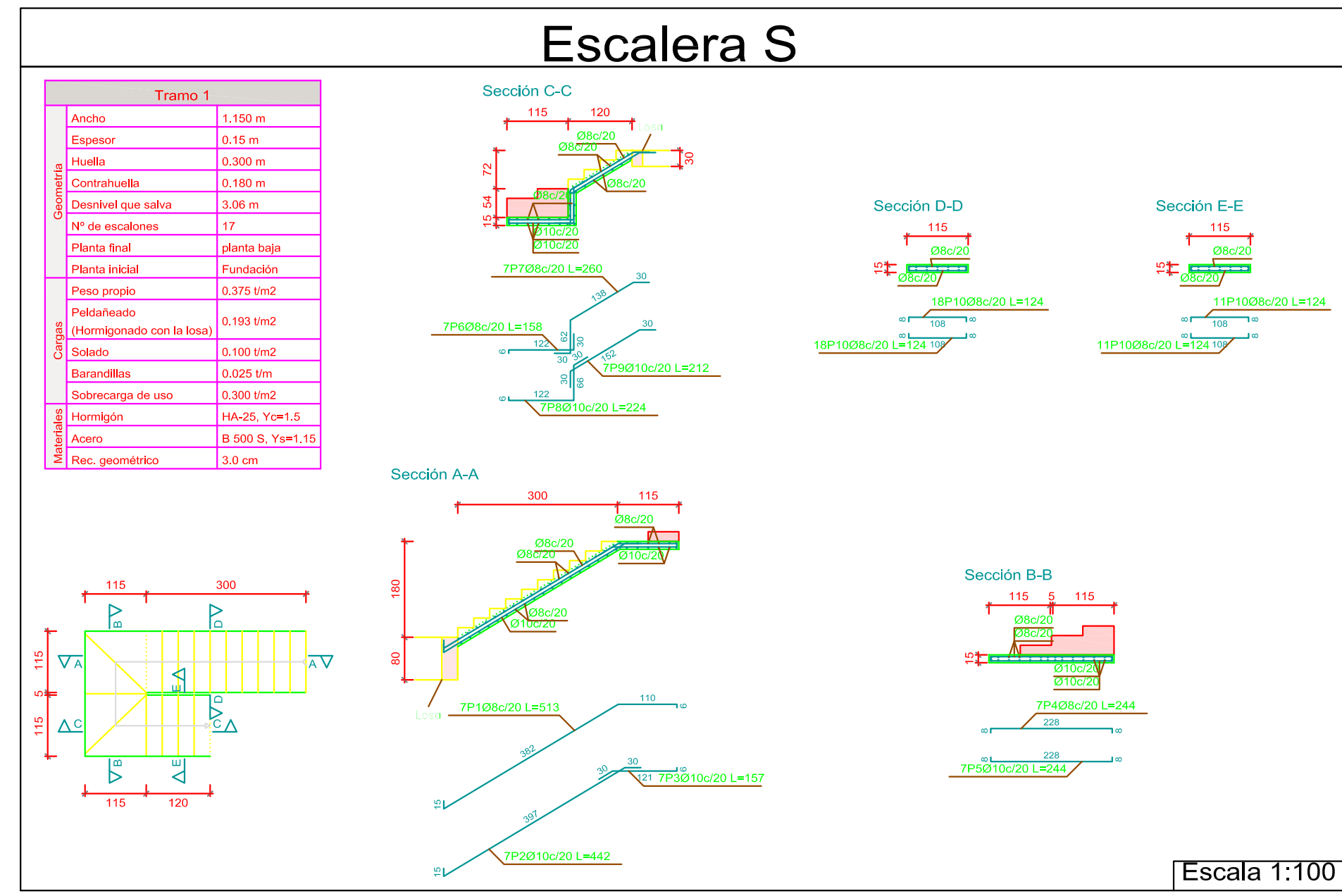

| Resumen Acero Escalera M2 | Long. total (m) | Peso+10% (kg) | Total |
|---------------------------|-----------------|---------------|-------|
| B 500 S, Y=1,15 Ø8 | 78,1 | 34 | 184 |
| Ø10 | 86,5 | 59 | 184 |
| Ø12 | 93,1 | 91 | 184 |

| Resumen Acero Escalera tipo | Long. total (m) | Peso+10% (kg) | Total |
|-----------------------------|-----------------|---------------|-------|
| B 500 S, Y=1,15 Ø8 | 78,1 | 34 | 184 |
| Ø10 | 86,5 | 59 | 184 |
| Ø12 | 93,1 | 91 | 184 |

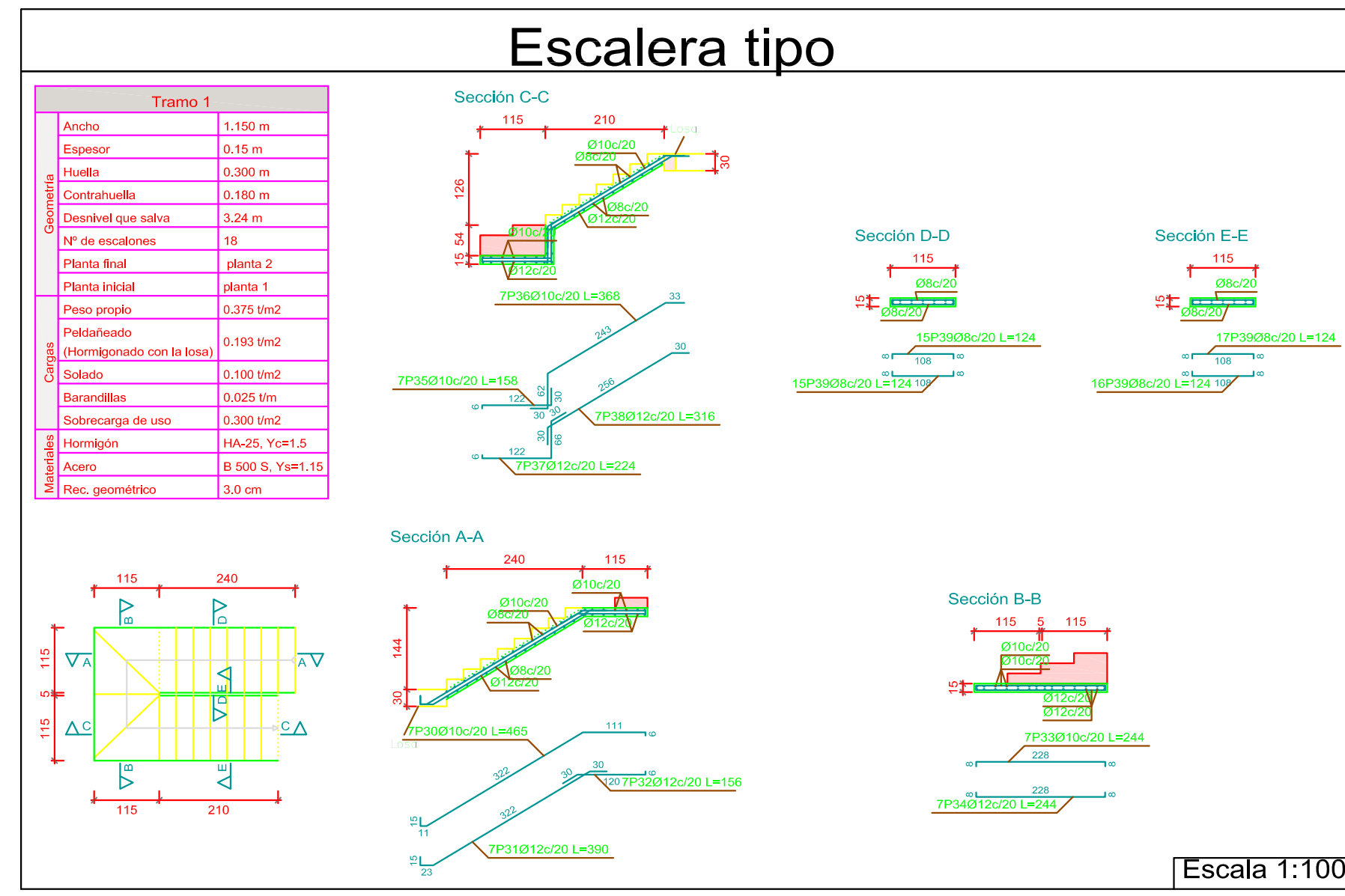
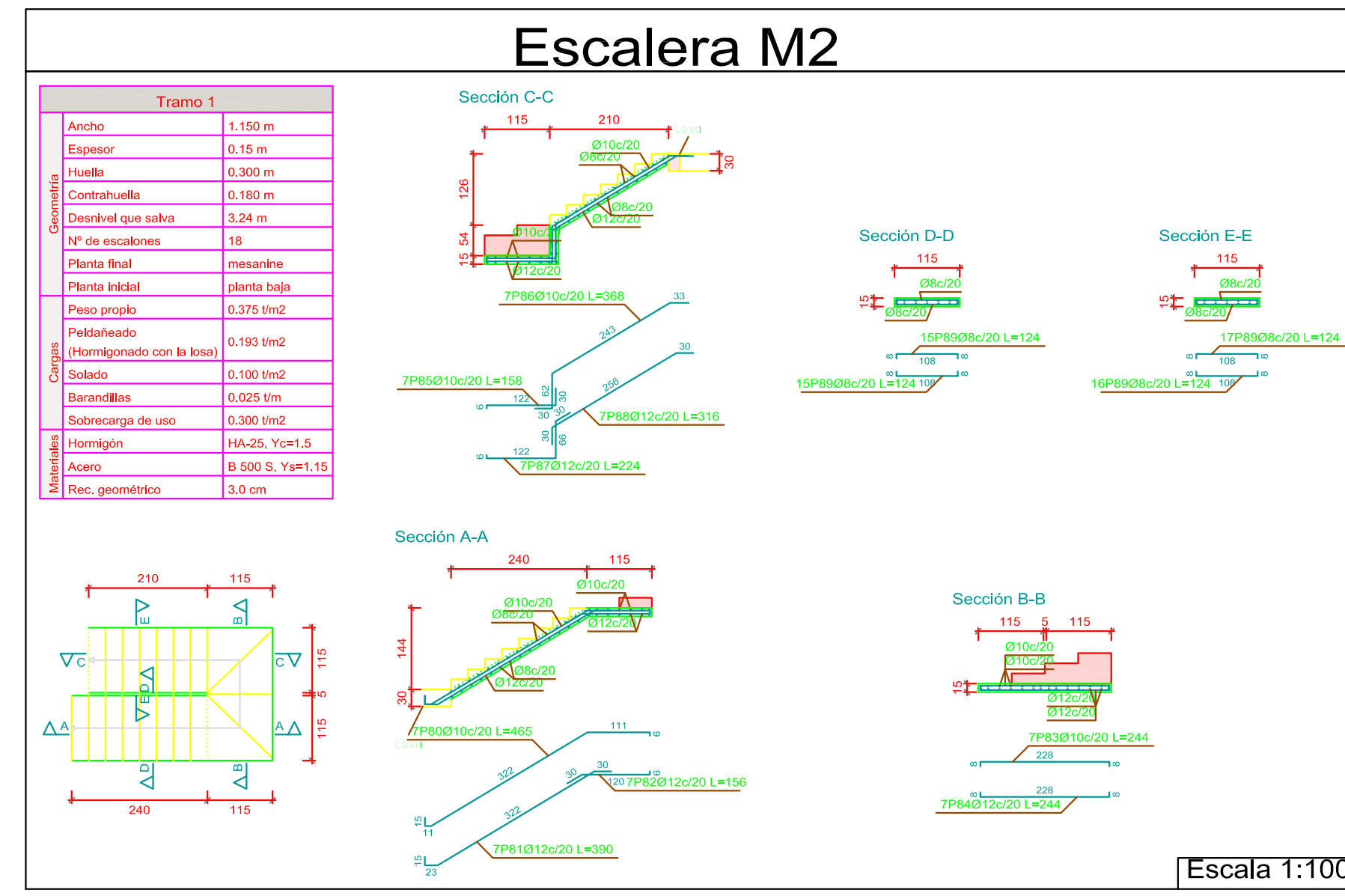

| Elemento | Pos. | Diam. | No. | Long. Total (cm) | Peso (kg) |
|----------|------|-------|-----|------------------|-----------|
| M1 | 1 | Ø10 | 25 | 2017 | 20,7 |
| | 2 | Ø12 | 25 | 2017 | 20,7 |
| M2 | 4 | Ø10 | 25 | 2017 | 20,7 |
| | 5 | Ø10 | 25 | 2017 | 20,7 |
| | 7 | Ø10 | 25 | 2017 | 20,7 |
| M3 | 8 | Ø10 | 25 | 2017 | 20,7 |
| | 9 | Ø10 | 25 | 2017 | 20,7 |
| | 10 | Ø10 | 25 | 2017 | 20,7 |
| | 11 | Ø10 | 25 | 2017 | 20,7 |
| M4 | 12 | Ø10 | 25 | 2017 | 20,7 |
| | 13 | Ø10 | 25 | 2017 | 20,7 |
| | 14 | Ø10 | 25 | 2017 | 20,7 |
| | 15 | Ø10 | 25 | 2017 | 20,7 |

| Resumen Acero Muros de hormigón armado | Long. total (m) | Peso+10% (kg) | Total |
|--|-----------------|---------------|-------|
| B 500 S, Y=1,15 Ø8 | 1033,2 | 448 | |
| Ø12 | 3583,9 | 3500 | |
| Ø16 | 2431,2 | 4221 | 8169 |

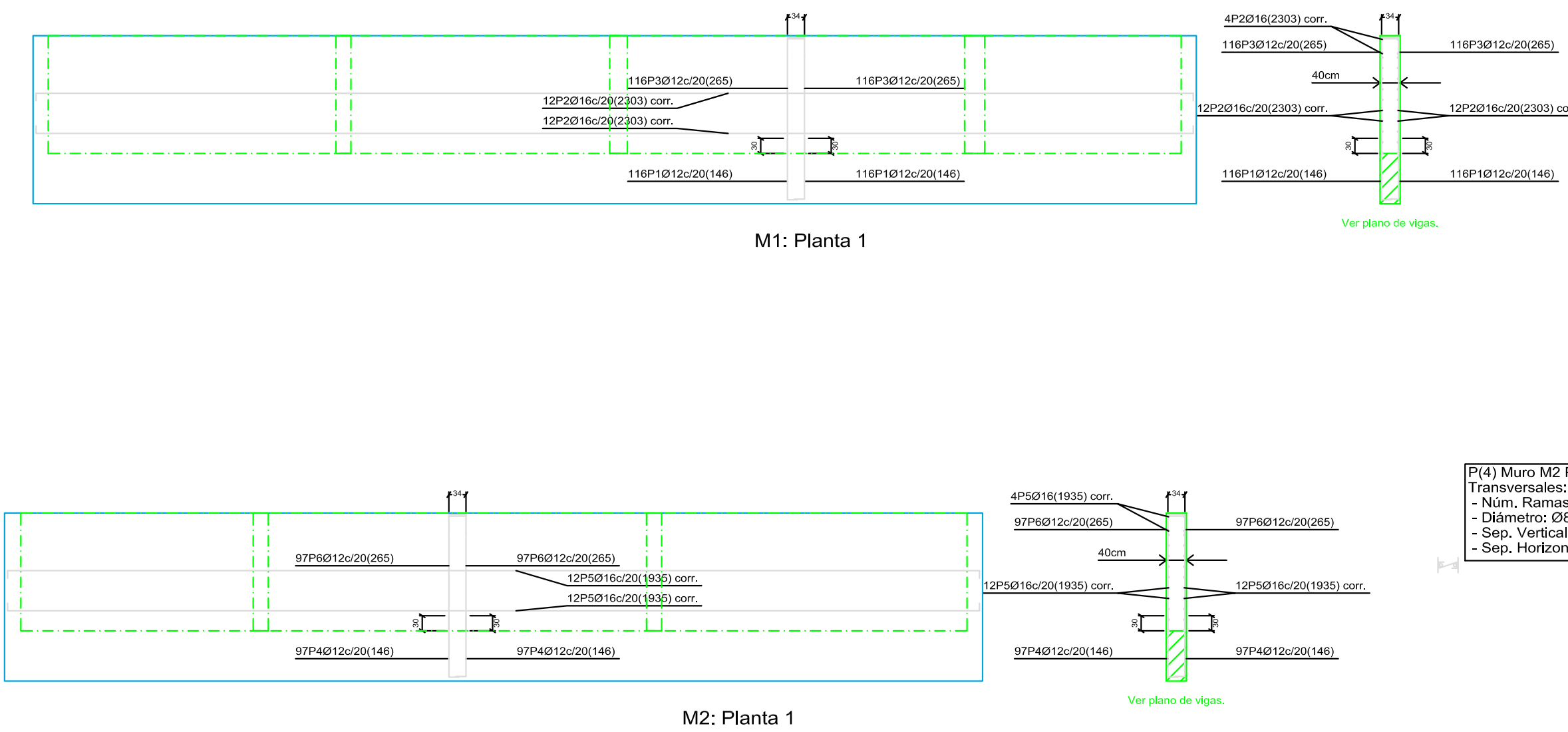

**UNIVERSIDAD AUTONOMA
"JUAN MISAEL SARACHO"
FACULTAD DE CIENCIAS Y
TECNOLOGIA**

PROYECTO:
**DISEÑO ESTRUCTURAL DEL EDIFICIO
PARA DEPARTAMENTOS EN EL BARRIO
LAS PANOSAS**

| | |
|--|--|
| CARACTER: PLANO DE ESCALERAS Y MUROS | DOCENTE: ING. CARRASCO ARNOLD PAUL DENNIS. |
|--|--|

| | | |
|--|-------------------|-------------------------|
| UNIVERSITARIO: HURTADO CACERES JOSUE | ESCALA: 1: 100 | LAMINA: 22/22 |
|--|-------------------|-------------------------|

| | | |
|------|-----------|----------------------|
| VoBo | GRUPO: IV | FECHA: JULIO DE 2022 |
|------|-----------|----------------------|