

**INSTALACION DE TELEFONO  
FIBRA OPTICA Y CAMARAS DE SEGURIDAD  
EDIFICIO TERMINAL PLANTA BAJA**

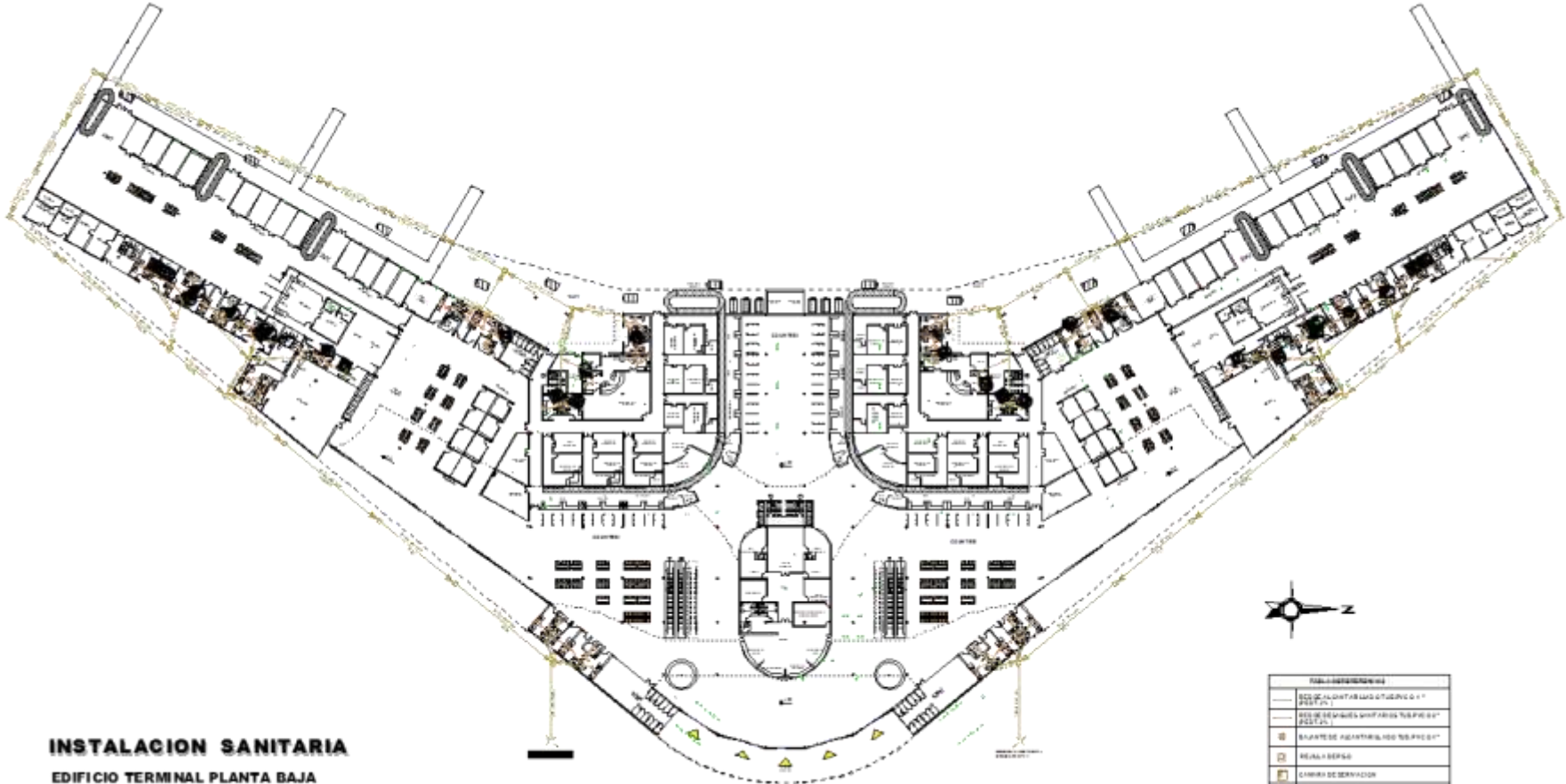

| LEYENDA |   |
|---------|---|
|         | RELLENO DE COBRILO                          |
|         | LINEA DE TELEFONO                           |
|         | LINEA DE FIBRA OPTICA PARA SEGURIDAD        |
|         | INDICACION DE REVISION DE S.                |
|         | LINEA DE CONTRA CORRIENTE PARA FIBRA OPTICA |
|         | LINEA DE CONTRA CORRIENTE PARA TELEFONO     |
|         | CARACTERES DE REVISION DE TELEFONO          |
|         | ARREDO AMPLIACION FIBRA OPTICA              |
|         | SALIDA CIRCULO DE REVISION DE S.            |
|         | SALIDA CIRCULO DE TELEFONO                  |
|         | SALIDA CIRCULO DE FIBRA OPTICA              |
|         | CAMARA DE SEGURIDAD                         |
|         | CONTRA INCENDIO                             |
|         | RACK  |



**INSTALACION SANITARIA**  
**EDIFICIO TERMINAL PLANTA BAJA**

| SIMBOLOGIA |  |
|------------|--|
|            | SOLERA DE ENTUBAMIENTO 100x100           |
|            | SOLERA DE MUEBLES Y/O FURNITURAS 100x100 |
|            | SOLERA DE ADAPTACION 100x100             |
|            | REJILLA DE DESBORDO                      |
|            | CAMBIO DE SERVICIO                       |
|            | CAMBIO DE PLANTA                         |
|            | CAMBIO DE DIRECCION                      |

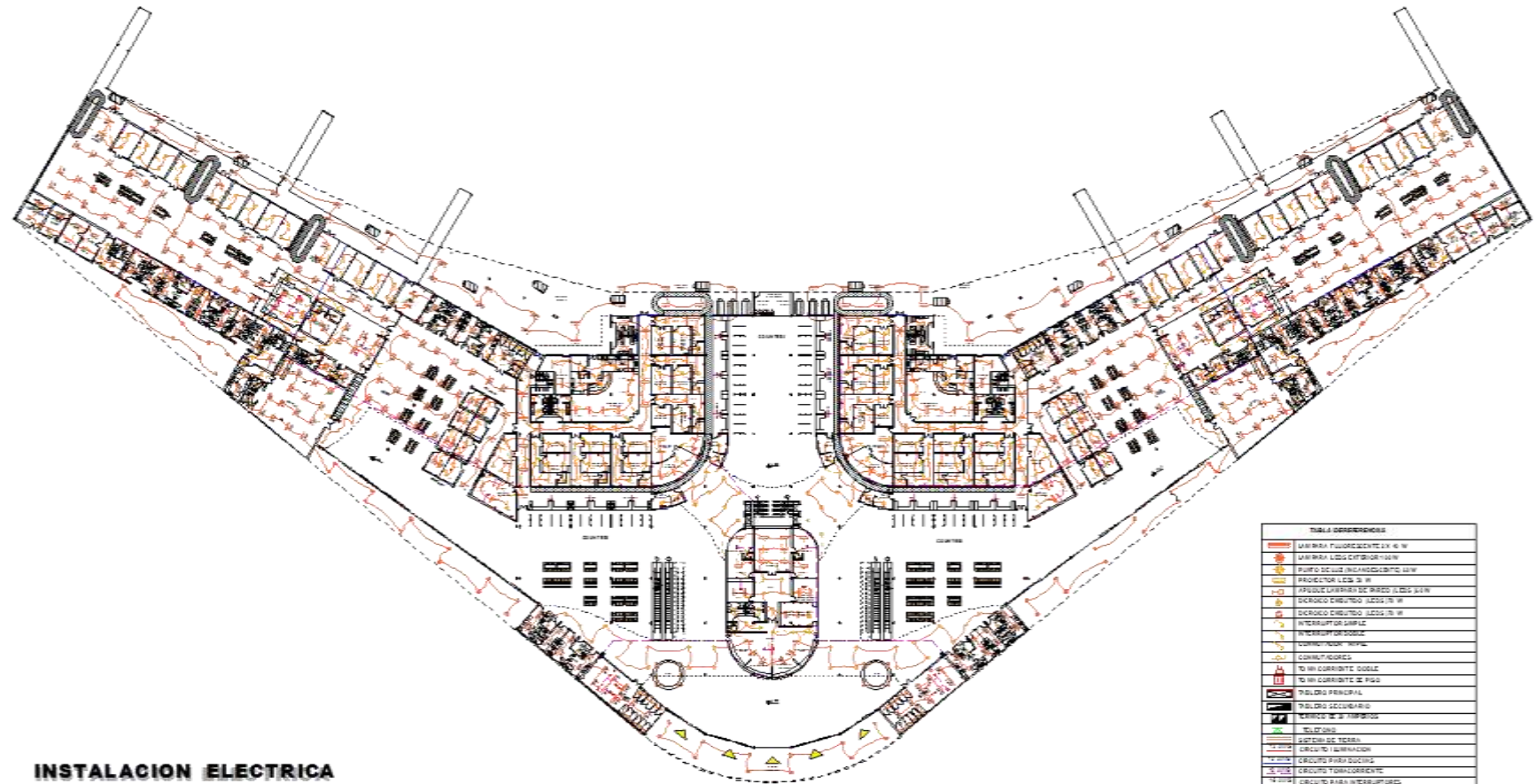

**INSTALACION ELECTRICA**  
**EDIFICIO TERMINAL PLANTA BAJA**

| TABLA DE REFERENCIAS |   |
|----------------------|---|
|                      | LAMPARA FLUORESCENTE 2x 6 W   |
|                      | LAMPARA LED COMPACTA 14W  |
|                      | PUNTO DE LUZ EMERGENCIA 14W   |
|                      | INTERRUPTOR 16A 2P  |
|                      | PUERTO DE CORRIENTE DE 220V 16A 2P  |
|                      | PUERTO DE CORRIENTE DE 110V 16A 2P  |
|                      | PUERTO DE CORRIENTE DE 110V 1P 16A  |
|                      | PUERTO DE CORRIENTE DE 110V 1P 10A  |
|                      | PUERTO DE CORRIENTE DE 110V 1P 5A   |
|                      | PUERTO DE CORRIENTE DE 110V 1P 2A   |
|                      | PUERTO DE CORRIENTE DE 110V 1P 1A   |
|                      | PUERTO DE CORRIENTE DE 110V 1P 0.5A   |
|                      | PUERTO DE CORRIENTE DE 110V 1P 0.25A  |
|                      | PUERTO DE CORRIENTE DE 110V 1P 0.125A   |
|                      | PUERTO DE CORRIENTE DE 110V 1P 0.0625A  |
|                      | PUERTO DE CORRIENTE DE 110V 1P 0.03125A   |
|                      | PUERTO DE CORRIENTE DE 110V 1P 0.015625A  |
|                      | PUERTO DE CORRIENTE DE 110V 1P 0.0078125A   |
|                      | PUERTO DE CORRIENTE DE 110V 1P 0.00390625A  |
|                      | PUERTO DE CORRIENTE DE 110V 1P 0.001953125A   |
|                      | PUERTO DE CORRIENTE DE 110V 1P 0.0009765625A  |
|                      | PUERTO DE CORRIENTE DE 110V 1P 0.00048828125A   |
|                      | PUERTO DE CORRIENTE DE 110V 1P 0.000244140625A  |
|                      | PUERTO DE CORRIENTE DE 110V 1P 0.0001220703125A   |
|                      | PUERTO DE CORRIENTE DE 110V 1P 0.00006103515625A  |
|                      | PUERTO DE CORRIENTE DE 110V 1P 0.000030517578125A   |
|                      | PUERTO DE CORRIENTE DE 110V 1P 0.0000152587890625A  |
|                      | PUERTO DE CORRIENTE DE 110V 1P 0.00000762939453125A   |
|                      | PUERTO DE CORRIENTE DE 110V 1P 0.000003814697265625A  |
|                      | PUERTO DE CORRIENTE DE 110V 1P 0.0000019073486328125A   |
|                      | PUERTO DE CORRIENTE DE 110V 1P 0.00000095367431640625A  |
|                      | PUERTO DE CORRIENTE DE 110V 1P 0.000000476837158203125A   |
|                      | PUERTO DE CORRIENTE DE 110V 1P 0.0000002384185791015625A  |
|                      | PUERTO DE CORRIENTE DE 110V 1P 0.00000011920928955078125A   |
|                      | PUERTO DE CORRIENTE DE 110V 1P 0.000000059604644775390625A  |
|                      | PUERTO DE CORRIENTE DE 110V 1P 0.0000000298023223876953125A   |
|                      | PUERTO DE CORRIENTE DE 110V 1P 0.00000001490116119384765625A  |
|                      | PUERTO DE CORRIENTE DE 110V 1P 0.000000007450580596923828125A   |
|                      | PUERTO DE CORRIENTE DE 110V 1P 0.0000000037252902984619140625A  |
|                      | PUERTO DE CORRIENTE DE 110V 1P 0.00000000186264514923095703125A   |
|                      | PUERTO DE CORRIENTE DE 110V 1P 0.000000000931322574615478515625A  |
|                      | PUERTO DE CORRIENTE DE 110V 1P 0.0000000004656612873077392578125A   |
|                      | PUERTO DE CORRIENTE DE 110V 1P 0.00000000023283064365386962890625A  |
|                      | PUERTO DE CORRIENTE DE 110V 1P 0.000000000116415321826934814453125A   |
|                      | PUERTO DE CORRIENTE DE 110V 1P 0.0000000000582076609134674071765625A  |
|                      | PUERTO DE CORRIENTE DE 110V 1P 0.00000000002910383045673370358828125A   |
|                      | PUERTO DE CORRIENTE DE 110V 1P 0.000000000014551915228366851794140625A  |
|                      | PUERTO DE CORRIENTE DE 110V 1P 0.0000000000072759576141834258970703125A   |
|                      | PUERTO DE CORRIENTE DE 110V 1P 0.00000000000363797880709171269853515625A  |
|                      | PUERTO DE CORRIENTE DE 110V 1P 0.0000000000018189894035458563242678125A   |
|                      | PUERTO DE CORRIENTE DE 110V 1P 0.00000000000090949470177292816213390625A  |
|                      | PUERTO DE CORRIENTE DE 110V 1P 0.000000000000454747350886464081066953125A   |
|                      | PUERTO DE CORRIENTE DE 110V 1P 0.0000000000002273736754432320405334765625A  |
|                      | PUERTO DE CORRIENTE DE 110V 1P 0.00000000000011368683772161602026673828125A   |
|                      | PUERTO DE CORRIENTE DE 110V 1P 0.000000000000056843418860808010133369140625A  |
|                      | PUERTO DE CORRIENTE DE 110V 1P 0.0000000000000284217094304040050667345703125A   |
|                      | PUERTO DE CORRIENTE DE 110V 1P 0.00000000000001421085471520200253336728515625A  |
|                      | PUERTO DE CORRIENTE DE 110V 1P 0.000000000000007105427357601001266683642578125A   |
|                      | PUERTO DE CORRIENTE DE 110V 1P 0.0000000000000035527136788005006333418212890625A  |
|                      | PUERTO DE CORRIENTE DE 110V 1P 0.000000000000001776356839400250316670910642578125A  |
|                      | PUERTO DE CORRIENTE DE 110V 1P 0.0000000000000008881784197001251583354552712890625A   |
|                      | PUERTO DE CORRIENTE DE 110V 1P 0.000000000000000444089209850062579167727635642578125A   |
|                      | PUERTO DE CORRIENTE DE 110V 1P 0.000000000000000222044604925031289583863817812890625A   |
|                      | PUERTO DE CORRIENTE DE 110V 1P 0.000000000000000111022302462515644791931690642578125A   |
|                      | PUERTO DE CORRIENTE DE 110V 1P 0.000000000000000055511151231257322395969545312890625A   |
|                      | PUERTO DE CORRIENTE DE 110V 1P 0.00000000000000002775557561562866119798477265642578125A                                       |
|                      | PUERTO DE CORRIENTE DE 110V 1P 0.00000000000000001387778780781433059899238632812890625A                                       |
|                      | PUERTO DE CORRIENTE DE 110V 1P 0.0000000000000000069388939039071652994961931642578125A  |
|                      | PUERTO DE CORRIENTE DE 110V 1P 0.00000000000000000346944695195358264974809658212890625A                                       |
|                      | PUERTO DE CORRIENTE DE 110V 1P 0.0000000000000000017347234759767913248740482912890625A  |
|                      | PUERTO DE CORRIENTE DE 110V 1P 0.00000000000000000086736173798839566243720241562890625A                                       |
|                      | PUERTO DE CORRIENTE DE 110V 1P 0.000000000000000000433680868994197831218601207812890625A                                      |
|                      | PUERTO DE CORRIENTE DE 110V 1P 0.00000000000000000021684043449709891560930060390642578125A                                    |
|                      | PUERTO DE CORRIENTE DE 110V 1P 0.00000000000000000010842021724854945780465030195312890625A                                    |
|                      | PUERTO DE CORRIENTE DE 110V 1P 0.0000000000000000000542101086242747289023251507812890625A                                     |
|                      | PUERTO DE CORRIENTE DE 110V 1P 0.0000000000000000000271050543121373644511625390642578125A                                     |
|                      | PUERTO DE CORRIENTE DE 110V 1P 0.000000000000000000013552527156068682225578125390642578125A                                   |
|                      | PUERTO DE CORRIENTE DE 110V 1P 0.000000000000000000006776263578034341127890625390642578125A                                   |
|                      | PUERTO DE CORRIENTE DE 110V 1P 0.0000000000000000000033881317890171705639453125390642578125A                                  |
|                      | PUERTO DE CORRIENTE DE 110V 1P 0.00000000000000000000169406589450858528197265625390642578125A                                 |
|                      | PUERTO DE CORRIENTE DE 110V 1P 0.000000000000000000000847032947254292640986328125390642578125A                                |
|                      | PUERTO DE CORRIENTE DE 110V 1P 0.000000000000000000000423516473627146320493164257812890625A                                   |
|                      | PUERTO DE CORRIENTE DE 110V 1P 0.00000000000000000000021175823681357316024658212890625390642578125A                           |
|                      | PUERTO DE CORRIENTE DE 110V 1P 0.000000000000000000000105879118406786580123291064257812890625A                                |
|                      | PUERTO DE CORRIENTE DE 110V 1P 0.0000000000000000000000529395592033932900616145312890625390642578125A                         |
|                      | PUERTO DE CORRIENTE DE 110V 1P 0.00000000000000000000002646977960169658003072726564257812890625A                              |
|                      | PUERTO DE CORRIENTE DE 110V 1P 0.000000000000000000000013234889800848290015363632812890625390642578125A                       |
|                      | PUERTO DE CORRIENTE DE 110V 1P 0.0000000000000000000000066174449004241450076818164257812890625390642578125A                   |
|                      | PUERTO DE CORRIENTE DE 110V 1P 0.000000000000000000000003308722450212072503840908212890625390642578125A                       |
|                      | PUERTO DE CORRIENTE DE 110V 1P 0.000000000000000000000001654361225106036250192045412890625390642578125A                       |
|                      | PUERTO DE CORRIENTE DE 110V 1P 0.0000000000000000000000008271806125530181250096022712890625390642578125A                      |
|                      | PUERTO DE CORRIENTE DE 110V 1P 0.000000000000000000000000413590306276509062500480113564257812890625390642578125A              |
|                      | PUERTO DE CORRIENTE DE 110V 1P 0.00000000000000000000000020679515313825453125002400567812890625390642578125A                  |
|                      | PUERTO DE CORRIENTE DE 110V 1P 0.0000000000000000000000001033975765691272656250012002839064257812890625390642578125A          |
|                      | PUERTO DE CORRIENTE DE 110V 1P 0.000000000000000000000000051698788284563632812500060014195312890625390642578125A              |
|                      | PUERTO DE CORRIENTE DE 110V 1P 0.0000000000000000000000000258493941422818164257812890625390642578125A                         |
|                      | PUERTO DE CORRIENTE DE 110V 1P 0.00000000000000000000000001292469707114409062539064257812890625390642578125A                  |
|                      | PUERTO DE CORRIENTE DE 110V 1P 0.000000000000000000000000006462348535572045312539064257812890625390642578125A                 |
|                      | PUERTO DE CORRIENTE DE 110V 1P 0.0000000000000000000000000032311742677860226562539064257812890625390642578125A                |
|                      | PUERTO DE CORRIENTE DE 110V 1P 0.00000000000000000000000000161558713389301132812539064257812890625390642578125A               |
|                      | PUERTO DE CORRIENTE DE 110V 1P 0.000000000000000000000000000807793566946505664257812890625390642578125A                       |
|                      | PUERTO DE CORRIENTE DE 110V 1P 0.0000000000000000000000000004038967834732528312539064257812890625390642578125A                |
|                      | PUERTO DE CORRIENTE DE 110V 1P 0.00000000000000000000000000020194839173662641562539064257812890625390642578125A               |
|                      | PUERTO DE CORRIENTE DE 110V 1P 0.000000000000000000000000000100974195868313207812539064257812890625390642578125A              |
|                      | PUERTO DE CORRIENTE DE 110V 1P 0.0000000000000000000000000000504870979341561039062539064257812890625390642578125A             |
|                      | PUERTO DE CORRIENTE DE 110V 1P 0.00000000000000000000000000002524354896707805195312539064257812890625390642578125A            |
|                      | PUERTO DE CORRIENTE DE 110V 1P 0.000000000000000000000000000012621774483539025976562539064257812890625390642578125A           |
|                      | PUERTO DE CORRIENTE DE 110V 1P 0.0000000000000000000000000000063108872417697648812539064257812890625390642578125A             |
|                      | PUERTO DE CORRIENTE DE 110V 1P 0.00000000000000000000000000000315544362088487244062539064257812890625390642578125A            |
|                      | PUERTO DE CORRIENTE DE 110V 1P 0.000000000000000000000000000001577721810442436220312539064257812890625390642578125A           |
|                      | PUERTO DE CORRIENTE DE 110V 1P 0.0000000000000000000000000000007888609052212181101562539064257812890625390642578125A          |
|                      | PUERTO DE CORRIENTE DE 110V 1P 0.00000000000000000000000000000039443045261059055507812539064257812890625390642578125A         |
|                      | PUERTO DE CORRIENTE DE 110V 1P 0.000000000000000000000000000000197215226305295277539064257812890625390642578125A              |
|                      | PUERTO DE CORRIENTE DE 110V 1P 0.000000000000000000000000000000098607613152647638876562539064257812890625390642578125A        |
|                      | PUERTO DE CORRIENTE DE 110V 1P 0.0000000000000000000000000000000493038065763238194382812539064257812890625390642578125A       |
|                      | PUERTO DE CORRIENTE DE 110V 1P 0.0000000000000000000000000000000246519032881619097191289062539064257812890625390642578125A    |
|                      | PUERTO DE CORRIENTE DE 110V 1P 0.000000000000000000000000000000012325951644080954859564257812890625390642578125A              |
|                      | PUERTO DE CORRIENTE DE 110V 1P 0.0000000000000000000000000000000061629758220404774297812539064257812890625390642578125A       |
|                      | PUERTO DE CORRIENTE DE 110V 1P 0.00000000000000000000000000000000308148791102023871489062539064257812890625390642578125A      |
|                      | PUERTO DE CORRIENTE DE 110V 1P 0.000000000000000000000000000000001540743955510119374445312539064257812890625390642578125A     |
|                      | PUERTO DE CORRIENTE DE 110V 1P 0.0000000000000000000000000000000007703719777550596872226562539064257812890625390642578125A    |
|                      | PUERTO DE CORRIENTE DE 110V 1P 0.00000000000000000000000000000000038518598887752984361132812539064257812890625390642578125A   |
|                      | PUERTO DE CORRIENTE DE 110V 1P 0.00000000000000000000000000000000019259299443876492180564257812890625390642578125A            |
|                      | PUERTO DE CORRIENTE DE 110V 1P 0.000000000000000000000000000000000096296497219382460902812539064257812890625390642578125A     |
|                      | PUERTO DE CORRIENTE DE 110V 1P 0.0000000000000000000000000000000000481482486096912304514062539064257812890625390642578125A    |
|                      | PUERTO DE CORRIENTE DE 110V 1P 0.000000000000000000000000000000000024074124304845615225564257812890625390642578125A           |
|                      | PUERTO DE CORRIENTE DE 110V 1P 0.0000000000000000000000000000000000120370621524228076127812539064257812890625390642578125A    |
|                      | PUERTO DE CORRIENTE DE 110V 1P 0.00000000000000000000000000000000000601853107621140380639062539064257812890625390642578125A   |
|                      | PUERTO DE CORRIENTE DE 110V 1P 0.000000000000000000000000000000000003009265538105701903195312539064257812890625390642578125A  |
|                      | PUERTO DE CORRIENTE DE 110V 1P 0.0000000000000000000000000000000000015046327690528509515976562539064257812890625390642578125A |
|                      | PUERTO DE CORRIENTE DE 110V 1P 0.000000000000000000000000000000000000752316384526425047598812539064257812890625390642578125A  |
|                      | PUERTO DE CORRIENTE DE 110V 1P 0.0000000000000000000000000000000000003761581922632125023799412539064257812890625390642578125A |
|                      |   |



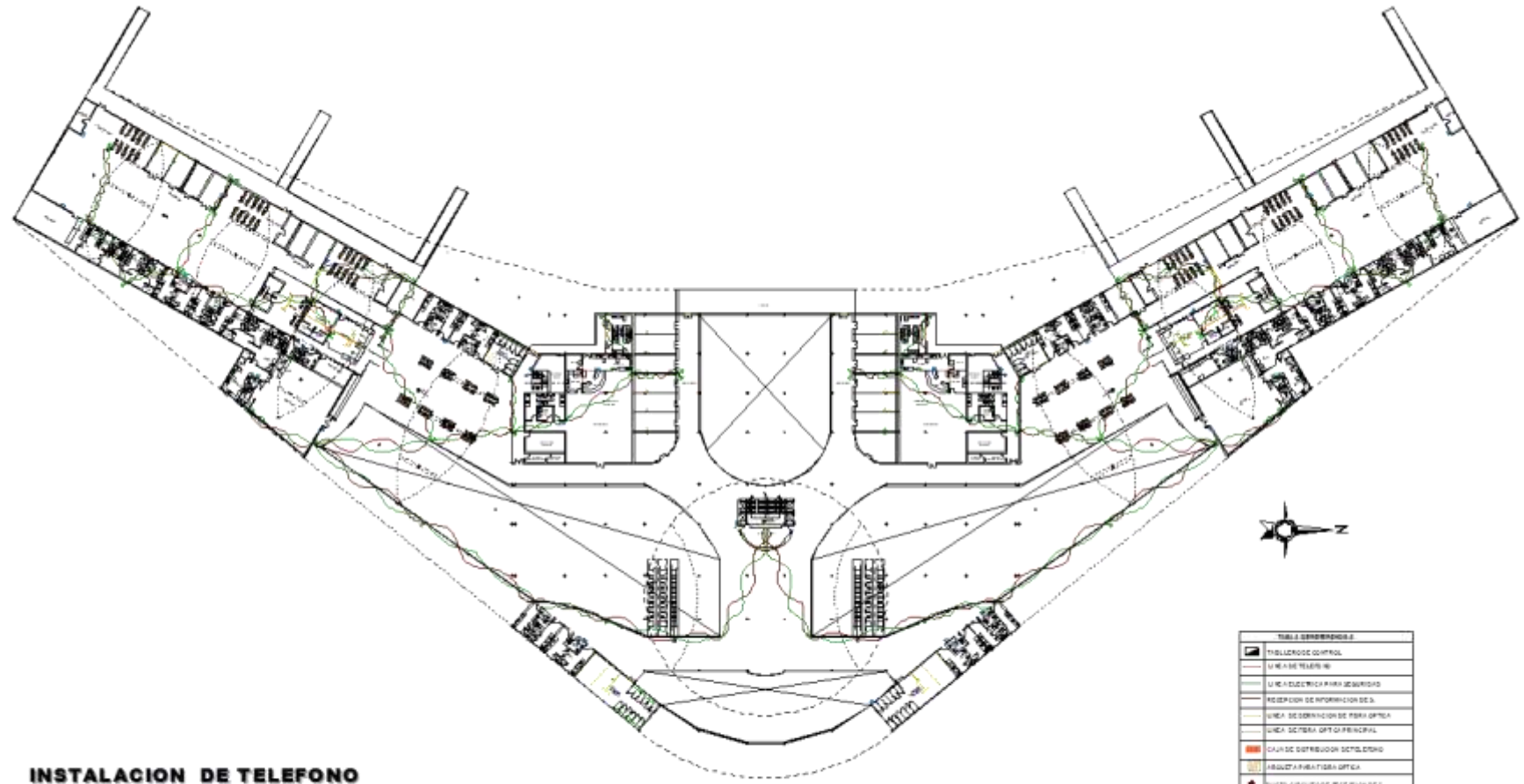

**INSTALACION DE TELEFONO  
FIBRA OPTICA Y CAMARAS DE SEGURIDAD**

**EDIFICIO TERMINAL PLANTA ALTA**

| TABLA DE REFERENCIAS |  |
|----------------------|--|
|                      | TRAYECTORIO CONTROL                    |
|                      | LINEA DE TELEFONIA                     |
|                      | LINEA ELECTRICA PARA SEGURIDAD         |
|                      | RECEPCION DE INFORMACION DE S.         |
|                      | LINEA DE DISTRIBUCION DE FIBRA OPTICA  |
|                      | LINEA DE DISTRIBUCION OPTICA PRINCIPAL |
|                      | CAJA DE DISTRIBUCION DETECCION         |
|                      | RESULTADO FIBRA OPTICA                 |
|                      | DUPLICADO CIRCUITOS TELEFONIA          |
|                      | DUPLICADO CIRCUITOS FIBRA OPTICA       |
|                      | CAMARA DE SEGURIDAD                    |
|                      | COPRIN INCENDIO                        |
|                      | RACK                                   |

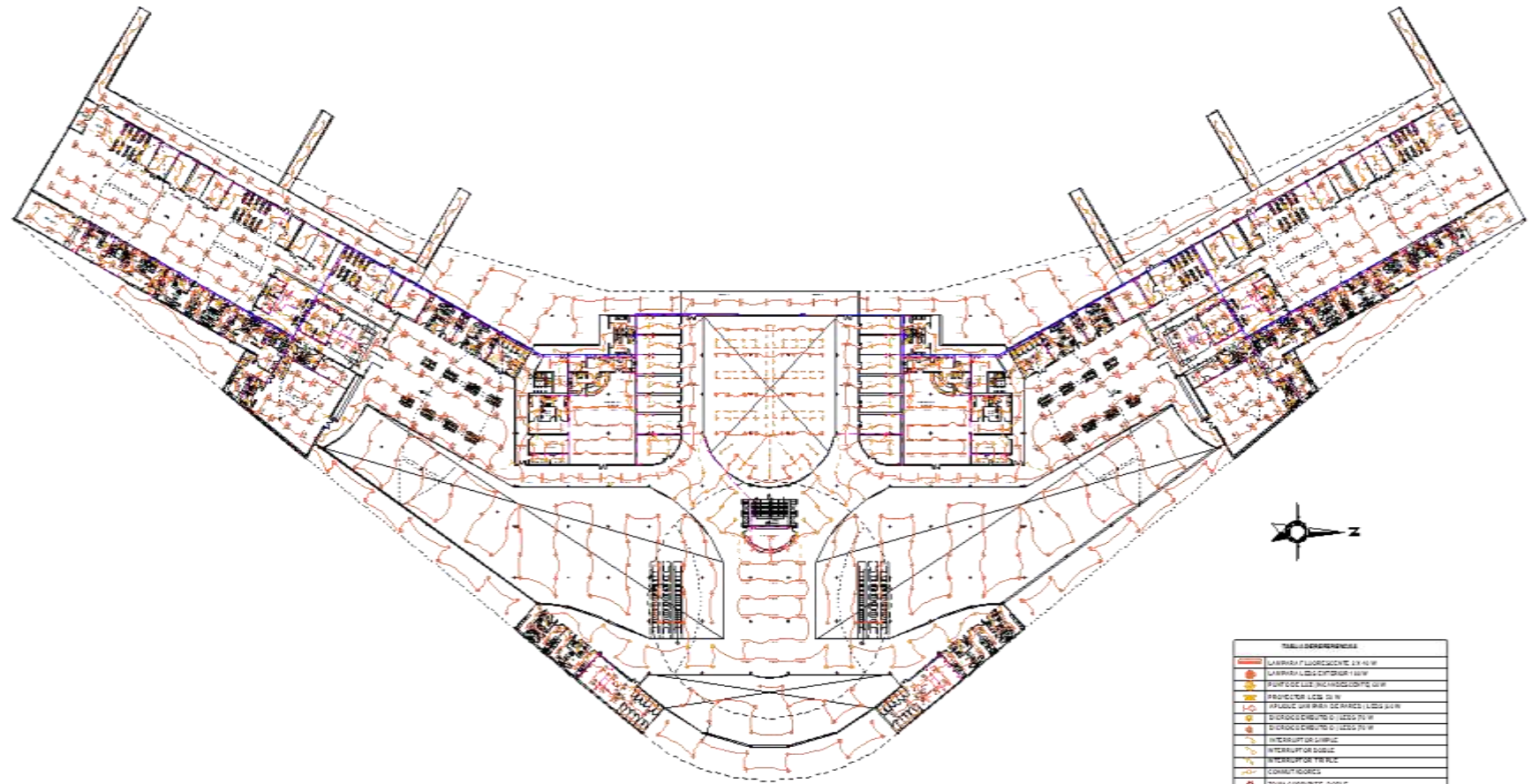

**INSTALACION ELECTRICA**  
**EDIFICIO TERMINAL PLANTA ALTA**

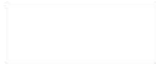

| TABLA REFERENCIAL |                                       |
|-------------------|---------------------------------------|
|                   | LAMPARA FLUORESCENTE 2x 1x 0.75       |
|                   | LAMPARA LED 0.5x0.5x0.75              |
|                   | PARQUE DE LUMEN EMERGENCIA 0.5x0.75   |
|                   | PROYECTOR LUMEN 0.5x0.75              |
|                   | PUENTE DE PWR 20 AMPERES 1.5x0.5x0.75 |
|                   | PUENTE DE DATOS 0.5x0.5x0.75          |
|                   | INTERRUPTOR SIMPLE                    |
|                   | INTERRUPTOR DOBLE                     |
|                   | INTERRUPTOR REGULABLE                 |
|                   | CONTACTORES                           |
|                   | TERMINAL CORRIENTE 300V               |
|                   | TERMINAL CORRIENTE 250V               |
|                   | TABLA PRINCIPAL                       |
|                   | TABLA SUBORDINADA                     |
|                   | TELEFONO                              |
|                   | PLACA DE TIERRA                       |
|                   | CIRCUIT BREAKER                       |
|                   | CIRCUIT BREAKER 100A                  |
|                   | CIRCUIT BREAKER 200A                  |
|                   | CIRCUIT BREAKER 400A                  |
|                   | CIRCUIT BREAKER 600A                  |
|                   | ALARMA ANTIFUEGO AUTOMATICO           |
|                   | NOTA                                  |

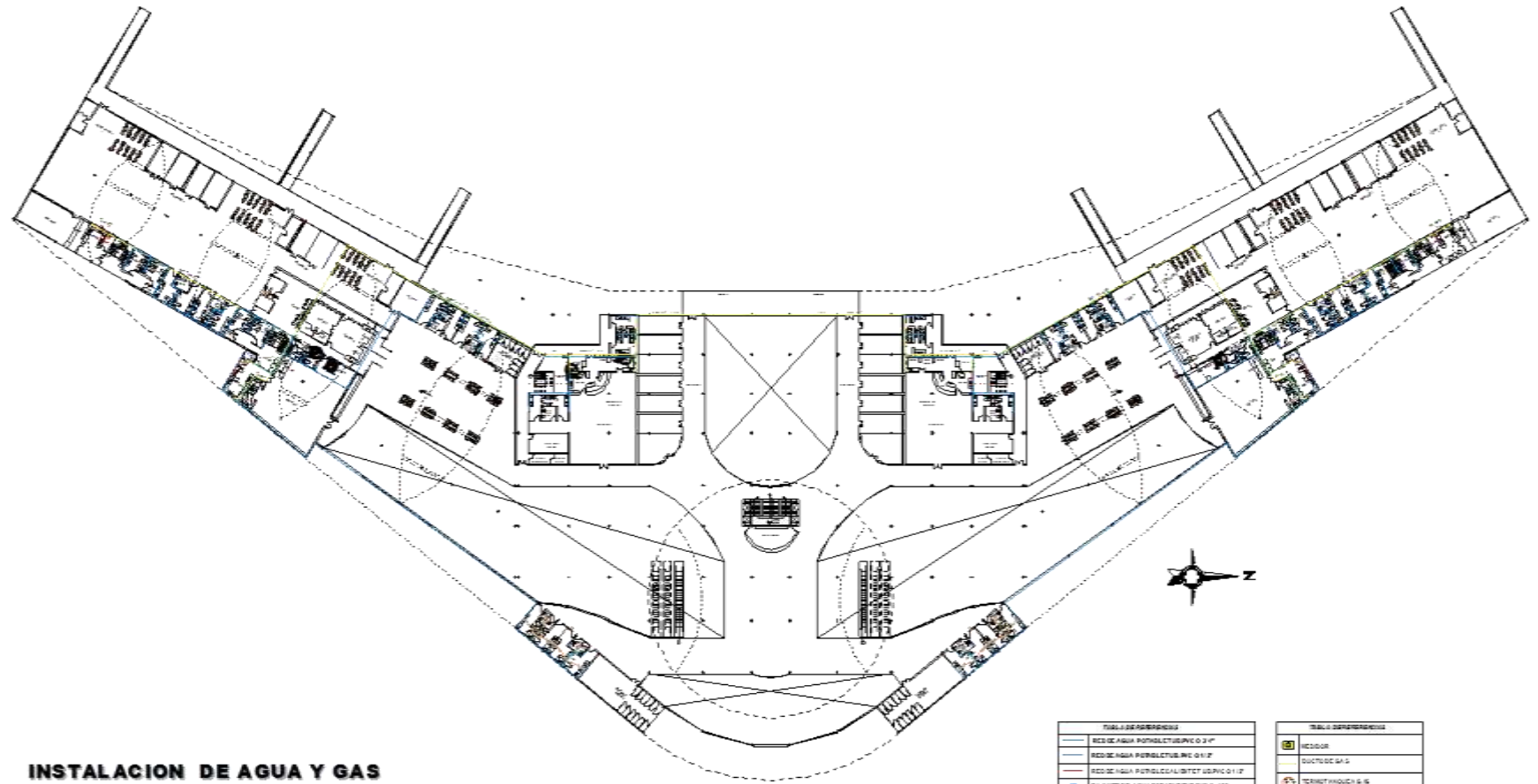

### INSTALACION DE AGUA Y GAS

EDIFICIO TERMINAL PLANTA ALTA

ESCALA 1:150



| SIMBOLIZACION |                                       |
|---------------|---------------------------------------|
|               | REDE AGUA POTABILIZADA Ø 2 1/2"       |
|               | REDE AGUA POTABILIZADA Ø 1 1/2"       |
|               | REDE AGUA POTABILIZADA Ø 1"           |
|               | SIJANTE DE AGUA POTABILIZADA Ø 1 1/2" |
|               | SIJANTE DE AGUA POTABILIZADA Ø 1"     |
|               | FRIGIF. GELADO                        |
|               | FRIGIF. GELADO                        |
|               | LINEAS F.G.D.                         |
|               | EE                                    |
|               | CSBO                                  |
|               | ESMARCASER                            |

| SIMBOLIZACION |                     |
|---------------|---------------------|
|               | RECIPIENTE          |
|               | DUCTOS G.D.         |
|               | TERMOSTATOS G. & G. |
|               | LINEAS F.G.D.       |
|               | EE                  |
|               | CSBO Ø 1"           |
|               | CSBO Ø 2"           |
|               | SIJ. G. GELADO      |

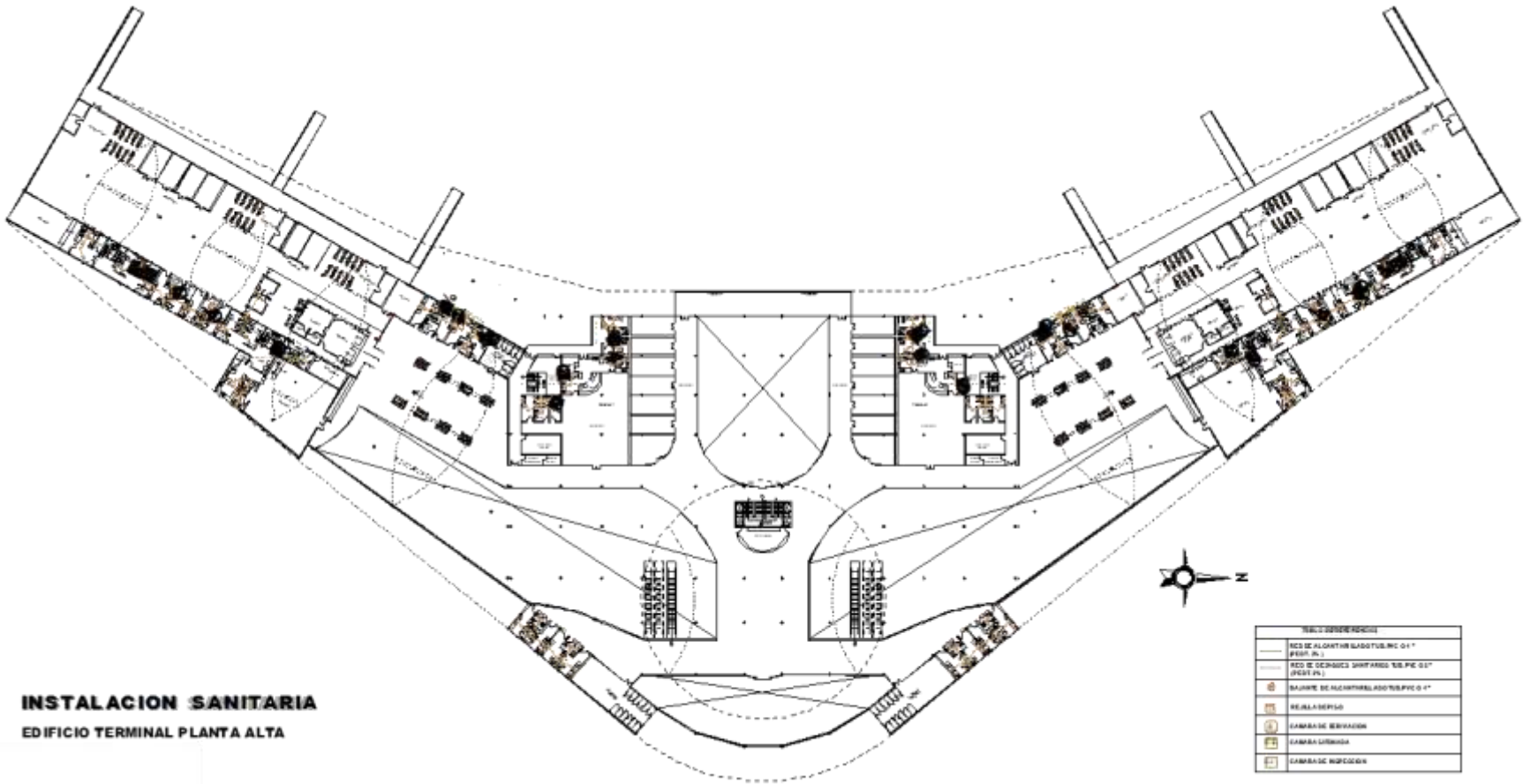

**INSTALACION SANITARIA**  
**EDIFICIO TERMINAL PLANTA ALTA**

| LEYENDA |                                   |
|---------|-----------------------------------|
|         | RED DE ALIVIAO SANITARIO 100 4"   |
|         | RED DE AGUA 100 4"                |
|         | RED DE GASES SANITARIOS 100 4"    |
|         | BAÑOS DE ALIVIAO SANITARIO 100 4" |
|         | W.C. DE SERVIDOR                  |
|         | CAMARA DE SERVIDOR                |
|         | CAMARA LIMPIA                     |
|         | CAMARA DE MARCHA                  |



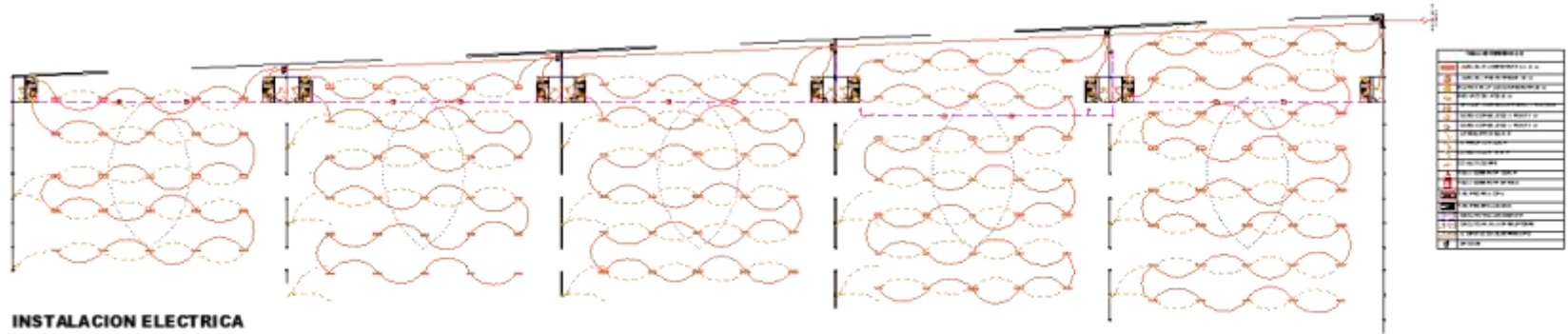

**INSTALACION ELECTRICA**

HANGARES PLANTA BAJA  
ESCALA 1:100

| LEYENDA  |  |
|----------|--|
| [Symbol] | ALAMBRE DE ALUMINIO 2x16   |
| [Symbol] | ALAMBRE DE ALUMINIO 2x10   |
| [Symbol] | ALAMBRE DE ALUMINIO 2x6  |
| [Symbol] | ALAMBRE DE ALUMINIO 2x4  |
| [Symbol] | ALAMBRE DE ALUMINIO 2x2  |
| [Symbol] | ALAMBRE DE ALUMINIO 2x1  |
| [Symbol] | ALAMBRE DE ALUMINIO 2x0.5  |
| [Symbol] | ALAMBRE DE ALUMINIO 2x0.25   |
| [Symbol] | ALAMBRE DE ALUMINIO 2x0.125  |
| [Symbol] | ALAMBRE DE ALUMINIO 2x0.0625   |
| [Symbol] | ALAMBRE DE ALUMINIO 2x0.03125  |
| [Symbol] | ALAMBRE DE ALUMINIO 2x0.015625   |
| [Symbol] | ALAMBRE DE ALUMINIO 2x0.0078125  |
| [Symbol] | ALAMBRE DE ALUMINIO 2x0.00390625   |
| [Symbol] | ALAMBRE DE ALUMINIO 2x0.001953125  |
| [Symbol] | ALAMBRE DE ALUMINIO 2x0.0009765625   |
| [Symbol] | ALAMBRE DE ALUMINIO 2x0.00048828125  |
| [Symbol] | ALAMBRE DE ALUMINIO 2x0.000244140625   |
| [Symbol] | ALAMBRE DE ALUMINIO 2x0.0001220703125  |
| [Symbol] | ALAMBRE DE ALUMINIO 2x0.00006103515625   |
| [Symbol] | ALAMBRE DE ALUMINIO 2x0.000030517578125  |
| [Symbol] | ALAMBRE DE ALUMINIO 2x0.0000152587890625   |
| [Symbol] | ALAMBRE DE ALUMINIO 2x0.00000762939453125  |
| [Symbol] | ALAMBRE DE ALUMINIO 2x0.000003814697265625   |
| [Symbol] | ALAMBRE DE ALUMINIO 2x0.0000019073486328125  |
| [Symbol] | ALAMBRE DE ALUMINIO 2x0.00000095367431640625   |
| [Symbol] | ALAMBRE DE ALUMINIO 2x0.000000476837158203125  |
| [Symbol] | ALAMBRE DE ALUMINIO 2x0.0000002384185791015625   |
| [Symbol] | ALAMBRE DE ALUMINIO 2x0.00000011920928955078125  |
| [Symbol] | ALAMBRE DE ALUMINIO 2x0.000000059604644775390625   |
| [Symbol] | ALAMBRE DE ALUMINIO 2x0.0000000298023223876953125  |
| [Symbol] | ALAMBRE DE ALUMINIO 2x0.00000001490116119384765625   |
| [Symbol] | ALAMBRE DE ALUMINIO 2x0.000000007450580596923828125  |
| [Symbol] | ALAMBRE DE ALUMINIO 2x0.0000000037252902984619140625   |
| [Symbol] | ALAMBRE DE ALUMINIO 2x0.00000000186264514923095703125  |
| [Symbol] | ALAMBRE DE ALUMINIO 2x0.000000000931322574615478515625   |
| [Symbol] | ALAMBRE DE ALUMINIO 2x0.0000000004656612873077392578125  |
| [Symbol] | ALAMBRE DE ALUMINIO 2x0.00000000023283064365386962890625   |
| [Symbol] | ALAMBRE DE ALUMINIO 2x0.000000000116415321826934814453125  |
| [Symbol] | ALAMBRE DE ALUMINIO 2x0.0000000000582076609134674071875  |
| [Symbol] | ALAMBRE DE ALUMINIO 2x0.00000000002910383045673370359375   |
| [Symbol] | ALAMBRE DE ALUMINIO 2x0.000000000014551915228366851796875  |
| [Symbol] | ALAMBRE DE ALUMINIO 2x0.0000000000072759576141834258984375   |
| [Symbol] | ALAMBRE DE ALUMINIO 2x0.00000000000363797880709171242921875  |
| [Symbol] | ALAMBRE DE ALUMINIO 2x0.000000000001818989403545856214609375   |
| [Symbol] | ALAMBRE DE ALUMINIO 2x0.0000000000009094947017729281073046875  |
| [Symbol] | ALAMBRE DE ALUMINIO 2x0.00000000000045474735088646405365234375   |
| [Symbol] | ALAMBRE DE ALUMINIO 2x0.000000000000227373675443232026826171875  |
| [Symbol] | ALAMBRE DE ALUMINIO 2x0.0000000000001136868377216160134130859375   |
| [Symbol] | ALAMBRE DE ALUMINIO 2x0.00000000000005684341886080800670654296875  |
| [Symbol] | ALAMBRE DE ALUMINIO 2x0.000000000000028421709430404003353271484375   |
| [Symbol] | ALAMBRE DE ALUMINIO 2x0.0000000000000142108547152020016766357421875  |
| [Symbol] | ALAMBRE DE ALUMINIO 2x0.00000000000000710542735760100083831787109375   |
| [Symbol] | ALAMBRE DE ALUMINIO 2x0.00000000000000355271367880050041915893546875   |
| [Symbol] | ALAMBRE DE ALUMINIO 2x0.000000000000001776356839400250209579467734375  |
| [Symbol] | ALAMBRE DE ALUMINIO 2x0.000000000000000888178419700125104789733869375  |
| [Symbol] | ALAMBRE DE ALUMINIO 2x0.0000000000000004440892098500625523948669346875   |
| [Symbol] | ALAMBRE DE ALUMINIO 2x0.00000000000000022204460492503127619743346834375  |
| [Symbol] | ALAMBRE DE ALUMINIO 2x0.000000000000000111022302462515638098716716671875   |
| [Symbol] | ALAMBRE DE ALUMINIO 2x0.0000000000000000555111512312578190493583583359375  |
| [Symbol] | ALAMBRE DE ALUMINIO 2x0.00000000000000002775557561562890952467917916796875   |
| [Symbol] | ALAMBRE DE ALUMINIO 2x0.000000000000000013877787807814454762339589583984375  |
| [Symbol] | ALAMBRE DE ALUMINIO 2x0.0000000000000000069388939039072273811697947916971875   |
| [Symbol] | ALAMBRE DE ALUMINIO 2x0.0000000000000000034694469519536136905848973958489375   |
| [Symbol] | ALAMBRE DE ALUMINIO 2x0.0000000000000000017347234759768068452924486979246875   |
| [Symbol] | ALAMBRE DE ALUMINIO 2x0.00000000000000000086736173798840342264622434896234375  |
| [Symbol] | ALAMBRE DE ALUMINIO 2x0.000000000000000000433680868994201711323112174481171875   |
| [Symbol] | ALAMBRE DE ALUMINIO 2x0.000000000000000000216840434497100855661560872240589375   |
| [Symbol] | ALAMBRE DE ALUMINIO 2x0.0000000000000000001084202172485504278307804361202946875  |
| [Symbol] | ALAMBRE DE ALUMINIO 2x0.00000000000000000005421010862427521391539021806014734375   |
| [Symbol] | ALAMBRE DE ALUMINIO 2x0.00000000000000000002710505431213760695769510903007369375   |
| [Symbol] | ALAMBRE DE ALUMINIO 2x0.000000000000000000013552527156068803478847554501503684375  |
| [Symbol] | ALAMBRE DE ALUMINIO 2x0.000000000000000000006776263578034401739423777500751841875  |
| [Symbol] | ALAMBRE DE ALUMINIO 2x0.0000000000000000000033881317890172008697118887503759209375   |
| [Symbol] | ALAMBRE DE ALUMINIO 2x0.00000000000000000000169406589450860043485594437518961046875  |
| [Symbol] | ALAMBRE DE ALUMINIO 2x0.000000000000000000000847032947254300217227772187594805234375   |
| [Symbol] | ALAMBRE DE ALUMINIO 2x0.00000000000000000000042351647362715010861138609379740269375  |
| [Symbol] | ALAMBRE DE ALUMINIO 2x0.000000000000000000000211758236813575005430569046898701346875   |
| [Symbol] | ALAMBRE DE ALUMINIO 2x0.000000000000000000000105879118406787500271529523449350671875   |
| [Symbol] | ALAMBRE DE ALUMINIO 2x0.000000000000000000000052939559203393750013576476172167839375   |
| [Symbol] | ALAMBRE DE ALUMINIO 2x0.0000000000000000000000264697796016968750006788235860839196875  |
| [Symbol] | ALAMBRE DE ALUMINIO 2x0.00000000000000000000001323488980084843750003394117703041984375   |
| [Symbol] | ALAMBRE DE ALUMINIO 2x0.00000000000000000000000661744490042421875000169705885154209375   |
| [Symbol] | ALAMBRE DE ALUMINIO 2x0.00000000000000000000000330872245021210937500008485294257709375   |
| [Symbol] | ALAMBRE DE ALUMINIO 2x0.0000000000000000000000016543612251060546875000042426471288546875   |
| [Symbol] | ALAMBRE DE ALUMINIO 2x0.000000000000000000000000827180612553027343750000212132356442734375   |
| [Symbol] | ALAMBRE DE ALUMINIO 2x0.00000000000000000000000041359030627651367187500001060661782213671875   |
| [Symbol] | ALAMBRE DE ALUMINIO 2x0.000000000000000000000000206795153138256839062500000530330891106889375  |
| [Symbol] | ALAMBRE DE ALUMINIO 2x0.0000000000000000000000001033975765691284195312500000265165445553446875   |
| [Symbol] | ALAMBRE DE ALUMINIO 2x0.0000000000000000000000000516987882845642097656250000013258272277672334375  |
| [Symbol] | ALAMBRE DE ALUMINIO 2x0.00000000000000000000000002584939414228210488281250000006629136138836166875   |
| [Symbol] | ALAMBRE DE ALUMINIO 2x0.0000000000000000000000000129246970711410524441562500000033145680694418334375   |
| [Symbol] | ALAMBRE DE ALUMINIO 2x0.00000000000000000000000000646234853557052622207812500000016572840347209166875  |
| [Symbol] | ALAMBRE DE ALUMINIO 2x0.0000000000000000000000000032311742677852631110390625000000082864201736045834375  |
| [Symbol] | ALAMBRE DE ALUMINIO 2x0.0000000000000000000000000016155871338926315550195312500000041432100868022916875  |
| [Symbol] | ALAMBRE DE ALUMINIO 2x0.0000000000000000000000000008077935669463157750097656250000020716050434011458375  |
| [Symbol] | ALAMBRE DE ALUMINIO 2x0.0000000000000000000000000004038967834731578875004882812500000103580252170057291875   |
| [Symbol] | ALAMBRE DE ALUMINIO 2x0.0000000000000000000000000002019483917365789437500244140625000000517901260850286458375  |
| [Symbol] | ALAMBRE DE ALUMINIO 2x0.0000000000000000000000000001009741958682894718750012207031250000002589506304251432291875   |
| [Symbol] | ALAMBRE DE ALUMINIO 2x0.00000000000000000000000000005048709793414473906250006103515625000001294753152125571619375  |
| [Symbol] | ALAMBRE DE ALUMINIO 2x0.000000000000000000000000000025243548967072369531250003051757812500000064737657606285958375                                       |
| [Symbol] | ALAMBRE DE ALUMINIO 2x0.000000000000000000000000000012621774483536184765625000152587890625000000323688288031429791875                                    |
| [Symbol] | ALAMBRE DE ALUMINIO 2x0.000000000000000000000000000006310887241768092382812500007629394531250000001618441440157148958375                                 |
| [Symbol] | ALAMBRE DE ALUMINIO 2x0.000000000000000000000000000003155443620884046191250000381469726562500000008092207200785744791875                                 |
| [Symbol] | ALAMBRE DE ALUMINIO 2x0.00000000000000000000000000000157772181044202309562500001907348632812500000040461036003928723958375                               |
| [Symbol] | ALAMBRE DE ALUMINIO 2x0.0000000000000000000000000000007888609052210115478125000009536743164062500000020230518001964361958375                             |
| [Symbol] | ALAMBRE DE ALUMINIO 2x0.00000000000000000000000000000039443045261050577390625000047683715820312500000101152590009821809791875                            |
| [Symbol] | ALAMBRE DE ALUMINIO 2x0.00000000000000000000000000000019721522630525288695312500002384185791015625000000505762950049109048958375                         |
| [Symbol] | ALAMBRE DE ALUMINIO 2x0.000000000000000000000000000000098607613152626443476562500011920928955078125000000252881475024554544791875                        |
| [Symbol] | ALAMBRE DE ALUMINIO 2x0.00000000000000000000000000000004930380657631322173906250000596046447753906250000012644073750122772723958375                      |
| [Symbol] | ALAMBRE DE ALUMINIO 2x0.0000000000000000000000000000000246519032881566108695312500029802322387695312500000063220368750061386361958375                    |
| [Symbol] | ALAMBRE DE ALUMINIO 2x0.0000000000000000000000000000000123259516440783054347656250001490116119384769531250000003161018437500306931809791875              |
| [Symbol] | ALAMBRE DE ALUMINIO 2x0.0000000000000000000000000000000061629758220391521739062500007450580596923828125000000158050921875001534659048958375              |
| [Symbol] | ALAMBRE DE ALUMINIO 2x0.0000000000000000000000000000000030814879110195760869531250003725290298461912500000007902546093750007673295244791875              |
| [Symbol] | ALAMBRE DE ALUMINIO 2x0.00000000000000000000000000000000154074395550978804347656250004656612873076953125000000395127304687500038366476223958375          |
| [Symbol] | ALAMBRE DE ALUMINIO 2x0.000000000000000000000000000000000770371977754894021739062500058207660934619125000000197563652343750001918323811958375            |
| [Symbol] | ALAMBRE DE ALUMINIO 2x0.0000000000000000000000000000000003851859888774470108695312500072759515313825683906250000098781826193750004791647609791875        |
| [Symbol] | ALAMBRE DE ALUMINIO 2x0.00000000000000000000000000000000019259299443872350543476562500090949470108695312500000123477263193750006235238048958375          |
| [Symbol] | ALAMBRE DE ALUMINIO 2x0.00000000000000000000000000000000009629649721936175271739062500011368683772161912500000154394523437500077176190244791875          |
| [Symbol] | ALAMBRE DE ALUMINIO 2x0.000000000000000000000000000000000048148248609680876386953125000142108547156080625000001930117619375000953529501223958375         |
| [Symbol] | ALAMBRE DE ALUMINIO 2x0.000000000000000000000000000000000024074124304840438193476562500017347230246251562500000246023523437500012170595011958375         |
| [Symbol] | ALAMBRE DE ALUMINIO 2x0.0000000000000000000000000000000000120370621524202190967390625000216840434497105625000003075292619375000150852950059791875        |
| [Symbol] | ALAMBRE DE ALUMINIO 2x0.000000000000000000000000000000000006018531076210109548390625000271050543125106080625000003842926319375000188126475029791875      |
| [Symbol] | ALAMBRE DE ALUMINIO 2x0.00000000000000000000000000000000000300926553810505477241953125000338813178901720086953125000047536526193750002351524750148958375 |
| [Symbol] | ALAMBRE DE ALUMINIO 2x0.00000000000000000000000000000000000150463276905252738620781250004235164736271501086953125000059420631937500029393117500744791875 |
| [Symbol] | ALAMBRE DE ALUMINIO 2x0.00000000000000000000000000000000000075231638452626369310390625000516944362715005434765625000074275763193750003673773750148958375 |
| [Symbol] | ALAMBRE DE ALUMINIO 2x0.00000000000000000000000000000000000037615819226313168455195312500063368828803142979125000009271963193750004536947500744791875    |
| [Symbol] | ALAMBRE DE ALUMINIO 2x0.00000000000000000000000000000000000018807909613156584227812500078143210086802291667187500011343893750148958375                   |
| [Symbol] | ALAMBRE DE ALUMINIO 2x0.000000000000000000000000000000000000094039548065782921139062500096286420173604583437500014019468750148958375                     |
| [Symbol] | ALAMBRE DE ALUMINIO 2x0.0000000000000000000000000000000000000470197740328914605695312500120368828803142979125000017019468750148958375                    |
| [Symbol] | ALAMBRE DE ALUMINIO 2x0.0000000000000000000000000000000000000235098870164457302847656250015018441440157148958343750002126468750148958375                 |
| [Symbol] | ALAMBRE DE ALUMINIO 2x0.000000000000000000000000000000000000011754943508222865142390625001877207031250000265165445553446875000265165445553446875         |
| [Symbol] | ALAMBRE DE ALUMINIO 2x0.00000000000000000000000000000000000000587747175411143257195312500234640368750004019468750148958375                               |
| [Symbol] | ALAMBRE  |

# HANGARES

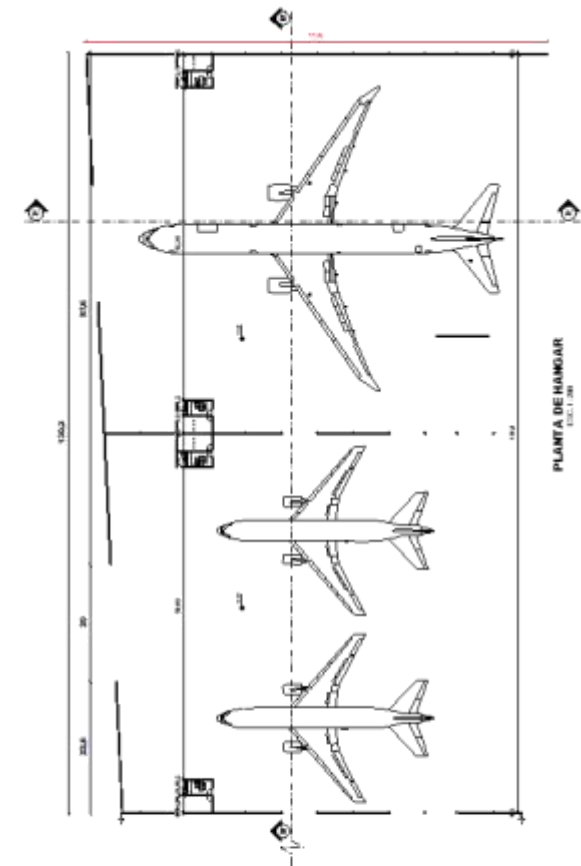
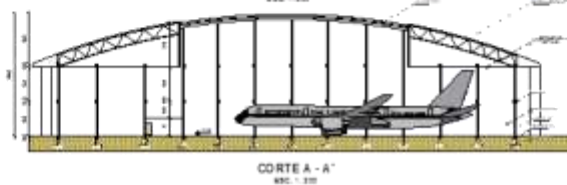
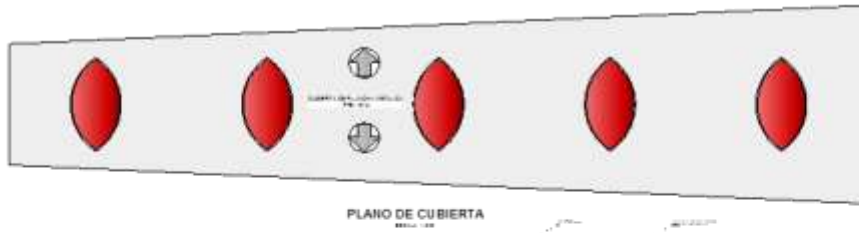
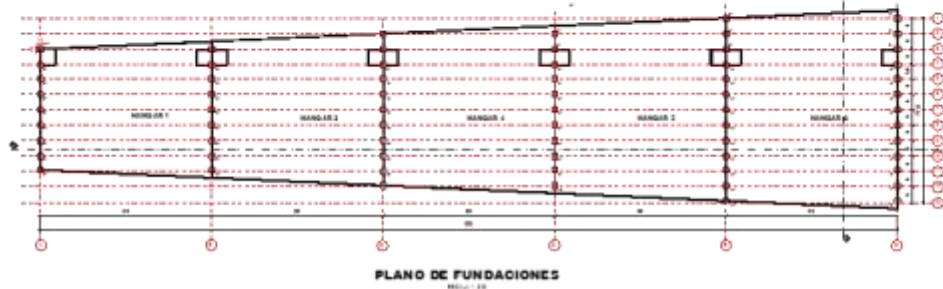
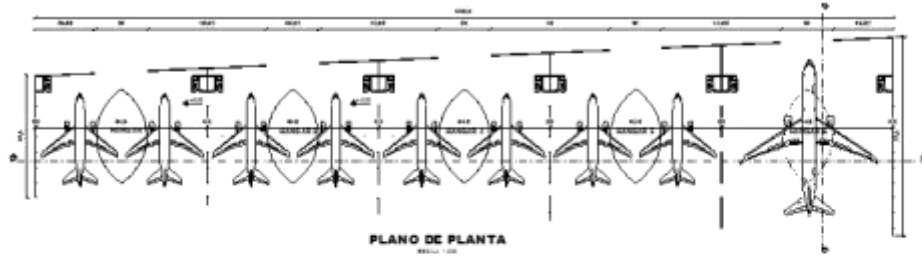



## EDIFICIO DE CARGA

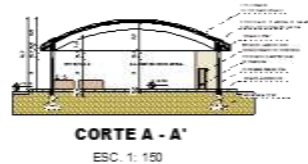
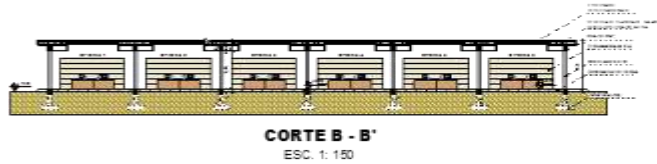
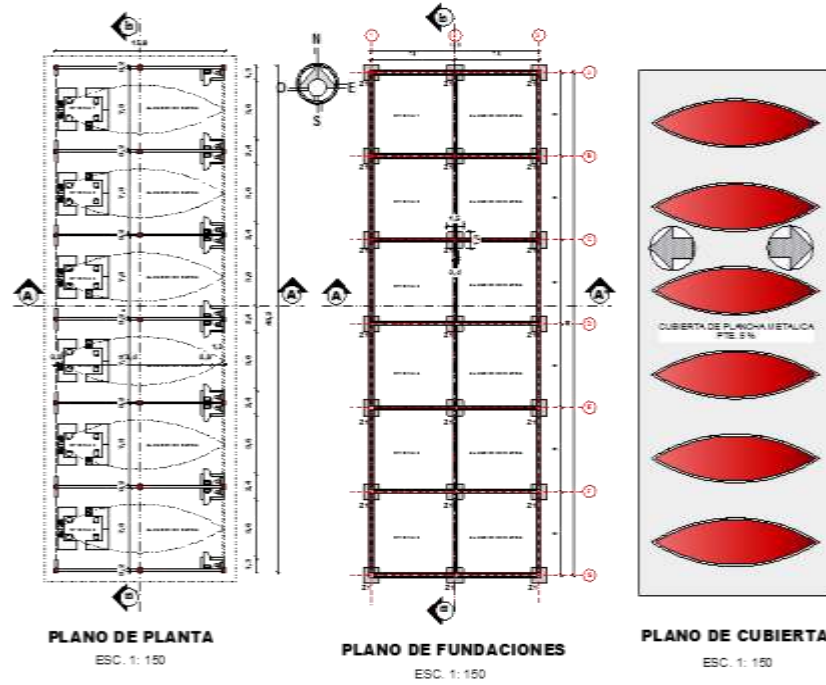

## EDIFICIO CONTRA INCENDIOS

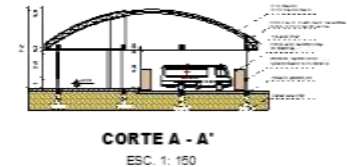
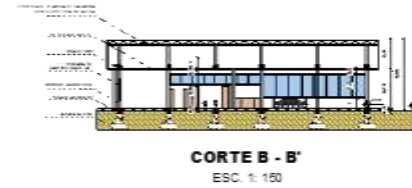
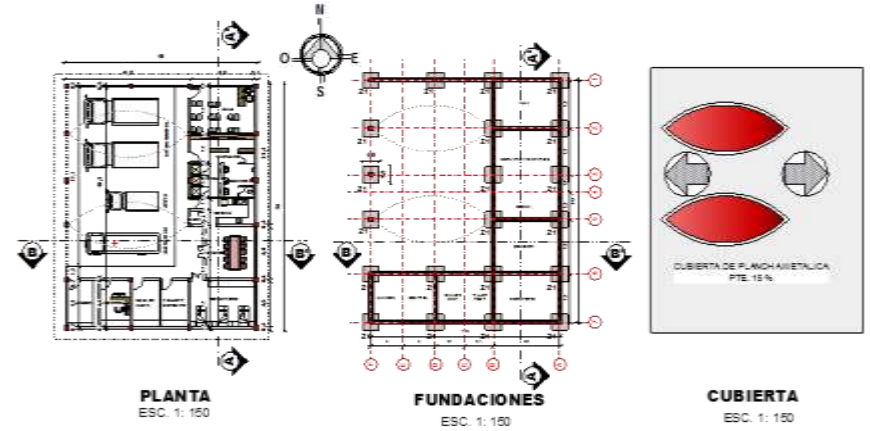

# TORRE DE CONTROL Y EDIFICIO ANEXO

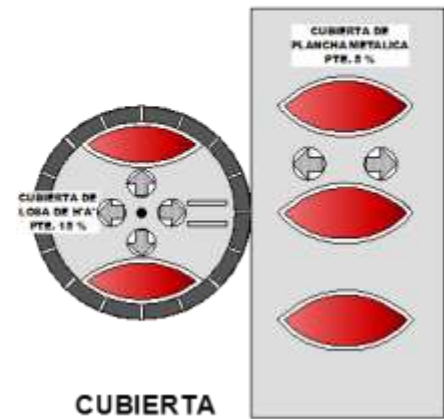
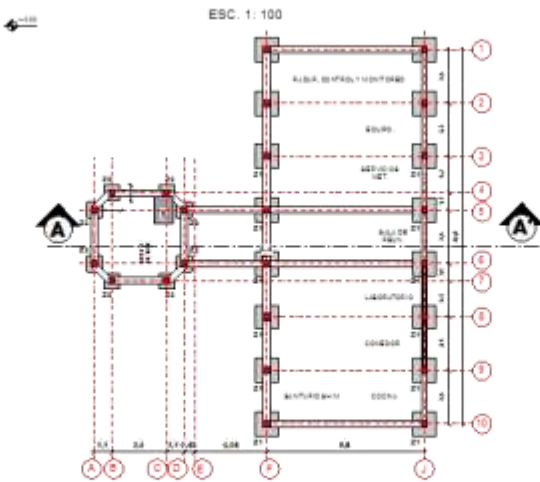
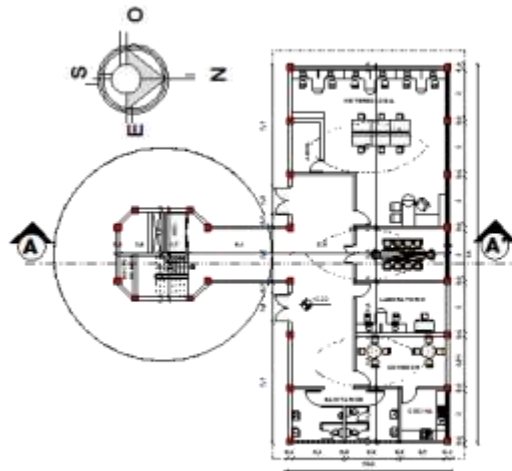
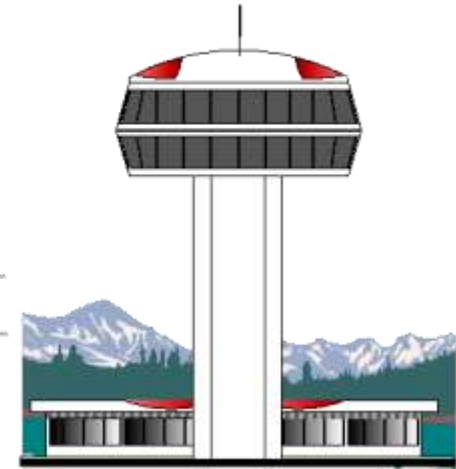
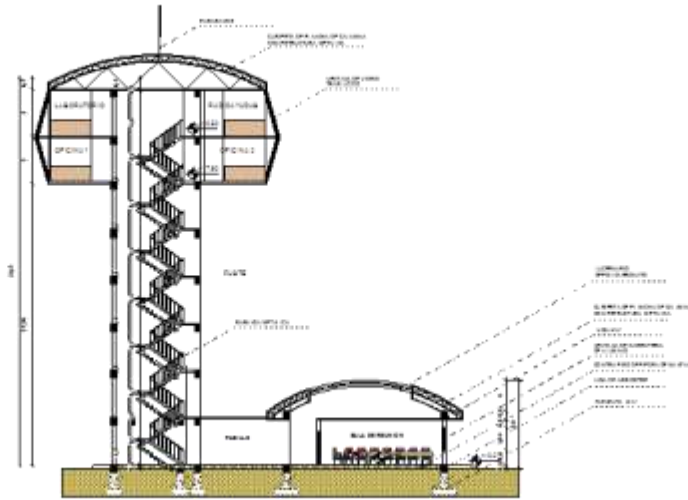
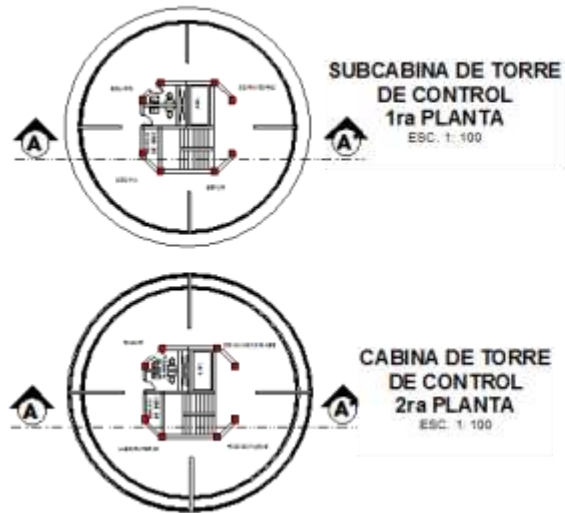

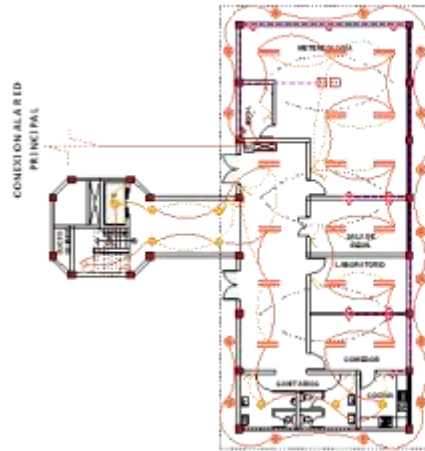

### Instalacion Electrica

ESC. 1: 100



### Instalacion Electrica Subcabin

ESC. 1: 100



### Instalacion Electrica Cabina

ESC. 1: 100

| TABLA DE REFERENCIAS |                                     |
|----------------------|-------------------------------------|
|                      | LAMPARA FLUORESCENTE 2 X 40 W       |
|                      | LAMPARA LEDS EXTERIOR 100 W         |
|                      | PUNTO DE LUZ (INCANDESCENTE) 80 W   |
|                      | PROYECTOR LED 80 W                  |
|                      | APLUSUE LAMPARA DE PARED (LED) 80 W |
|                      | CIRCULO EMBUTIDO (LED) 75 W         |
|                      | CIRCULO EMBUTIDO (LED) 75 W         |
|                      | INTERRUPTOR SIMPLE                  |
|                      | INTERRUPTOR DOBLE                   |
|                      | COMUTADOR TRIPLE                    |
|                      | COMUTADORES                         |
|                      | TOMA CORRIENTE DOBLE                |
|                      | TOMA CORRIENTE DE 10A               |
|                      | TABLERO PRINCIPAL                   |
|                      | TABLERO SECUNDARIO                  |
|                      | CIRCUITO TOMACORRIENTE              |
|                      | CIRCUITO PARA INTERRUPTORES         |
|                      | ALINEACION SUBTERRANEO              |
|                      | MEDIDOR                             |

| TABLA DE REFERENCIAS |   |
|----------------------|---|
|                      | RED DE AGUA POTABLE TUB.PVC Ø 1/2"            |
|                      | RED DE AGUA POTABLE TUB.PVC Ø 1"              |
|                      | RED DE AGUA POTABLE CALIENTE TUB.PVC Ø 1 1/2" |
|                      | BAJANTE DE AGUA POTABLE TUB.PVC Ø 1/2"        |
|                      | TANQUE ELEVADO                                |
|                      | TANQUE BAJO                                   |
|                      | LLAVE DE 80                                   |
|                      | TEE   |
|                      | CODO  |
|                      | BOMBA DE AGUA                                 |

| TABLA DE REFERENCIAS |                   |
|----------------------|-------------------|
|                      | MEDIDOR           |
|                      | DUCTO DE GAS      |
|                      | TERNOTANQUE A GAS |
|                      | LLAVE DE 80       |
|                      | TEE               |
|                      | CODO DE 90°       |
|                      | CODO DE 45°       |
|                      | BAJAO SUBE        |

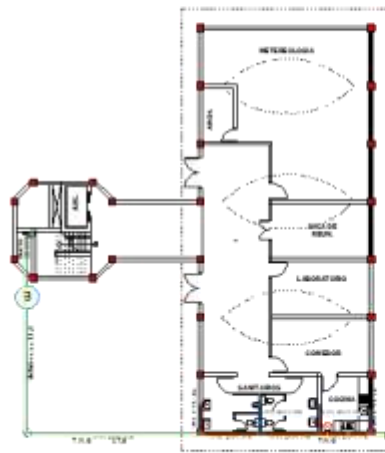

### Instalacion Agua y Gas

ESC. 1: 100

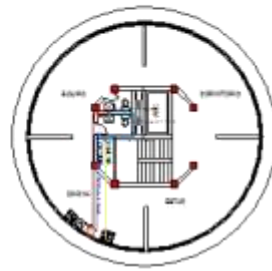

### Instalacion Agua y Gas Subcabin

ESC. 1: 100

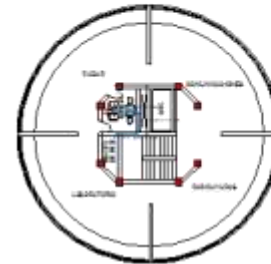

### Instalacion Agua y Gas Cabina

ESC. 1: 100

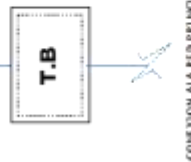

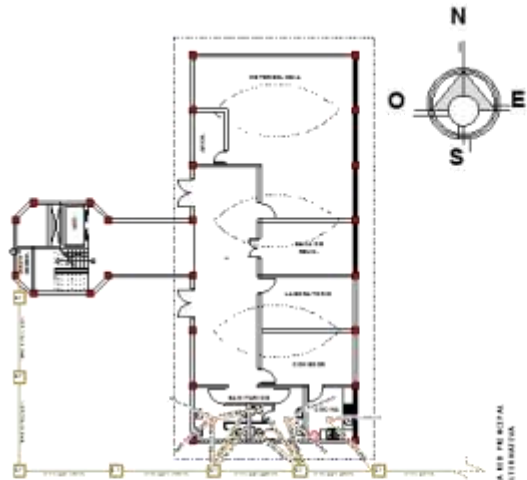

### Instalacion Sanitaria

ESC. 1: 100

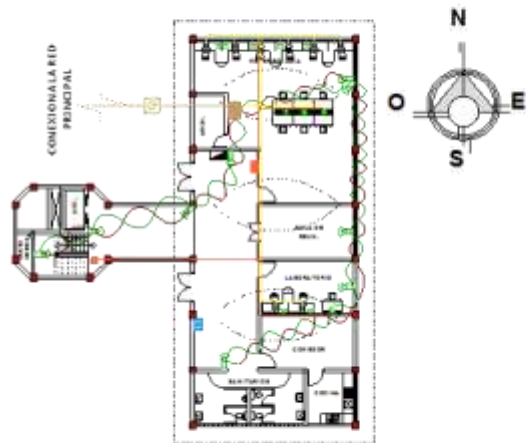

### Instalacion Sanitaria Subcabina

ESC. 1: 100

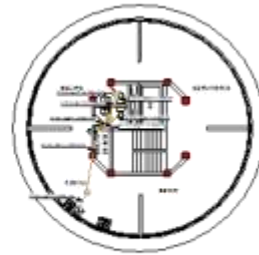

### Instalacion Sanitaria Cabina

ESC. 1: 100

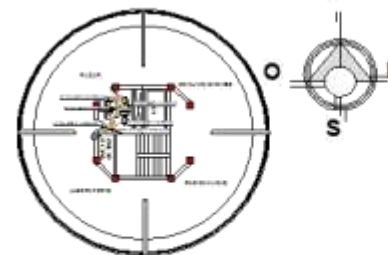

### Instalacion Agua y Gas Cabina

ESC. 1: 100

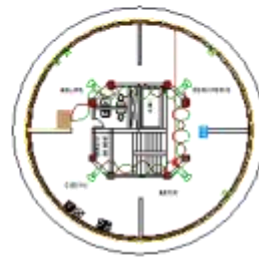

### Instalacion Agua y Gas Cabina

ESC. 1: 100

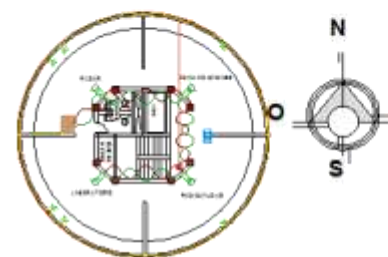

### Instalacion de Telefono, Fibra Optica y camaras de Seguridad

ESC. 1: 100

| TABLA DE REFERENCIAS |   |
|----------------------|---|
|                      | RED DE ALCANTARILLADO TUB.PVC Ø 4" (PRED. 2%)     |
|                      | RED DE DESAGUES SANITARIO TUB.PVC Ø 2" (PRED. 2%) |
|                      | RED DE AGUA POTABLE TUB.PVC Ø 3/4"                |
|                      | RED DE AGUA POTABLE TUB.PVC Ø 1/2"                |
|                      | BAJANTE DE ALCANTARILLADO TUB.PVC Ø 4"            |
|                      | BAJANTE DE AGUA POTABLE TUB.PVC Ø 1/2"            |
|                      | REJILLA DE FIBRO                                  |
|                      | CAMARA DE OBSERVACION                             |
|                      | CAMARA EFONADA                                    |
|                      | CAMARA DE INSPECCION                              |

| TABLA DE REFERENCIAS |                                     |
|----------------------|-------------------------------------|
|                      | TABLERO DE CONTROL                  |
|                      | LINIA DE TELEFONO                   |
|                      | LINIA ELCTRICA PARA SEGURIDAD       |
|                      | RECEPCION DE INFORMACION DE S.      |
|                      | LINIA DE DERIVACION DE FIBRA OPTICA |
|                      | LINIA DE FIBRA OPTICA PRINCIPAL     |
|                      | CAJA DE DISTRIBUCION DE TELEFONO    |
|                      | ARQUETA PARA FIBRA OPTICA           |
|                      | DUCTO CIRCUITO DE RECEPCION DE S.   |
|                      | DUCTO DE CIRCUITO DE TELEFONO       |
|                      | DUCTO DE CIRCUITO DE FIBRA OPTICA   |
|                      | CAMARA DE SEGURIDAD                 |
|                      | CONTRA INCENDIOS                    |
|                      | RACK                                |

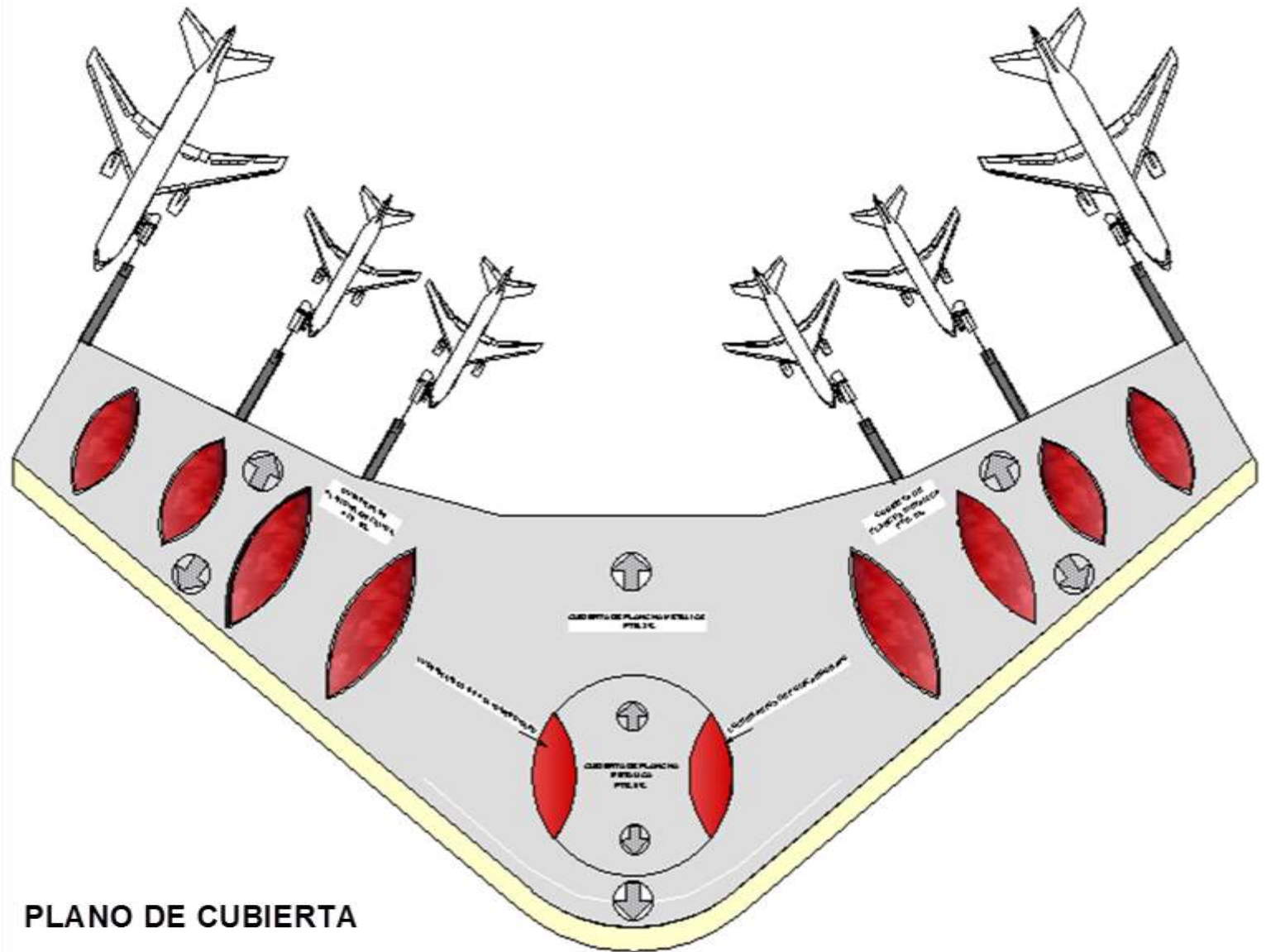

**PLANO DE CUBIERTA**



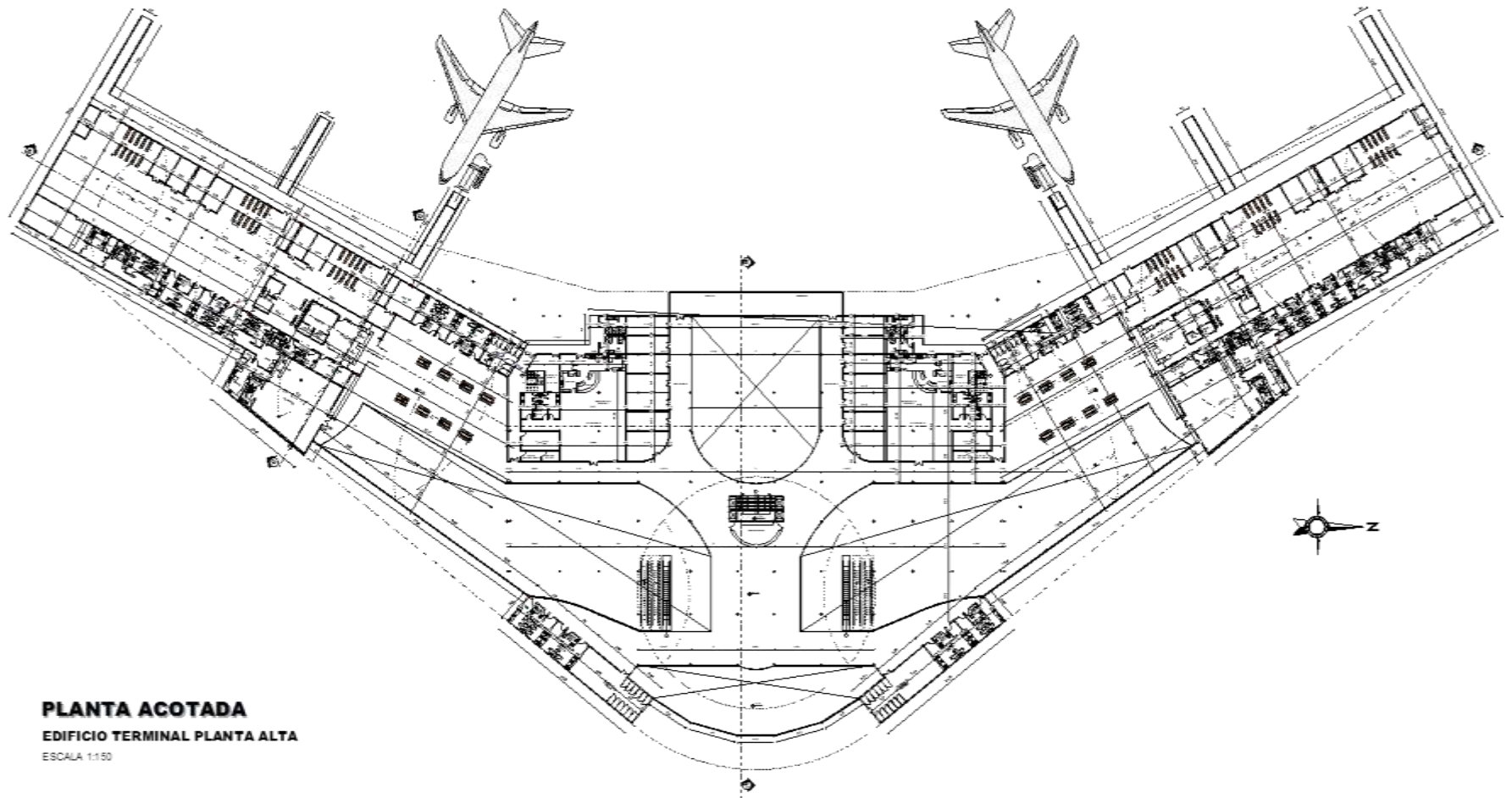

**PLANTA ACOTADA**  
**EDIFICIO TERMINAL PLANTA ALTA**  
ESCALA 1:150

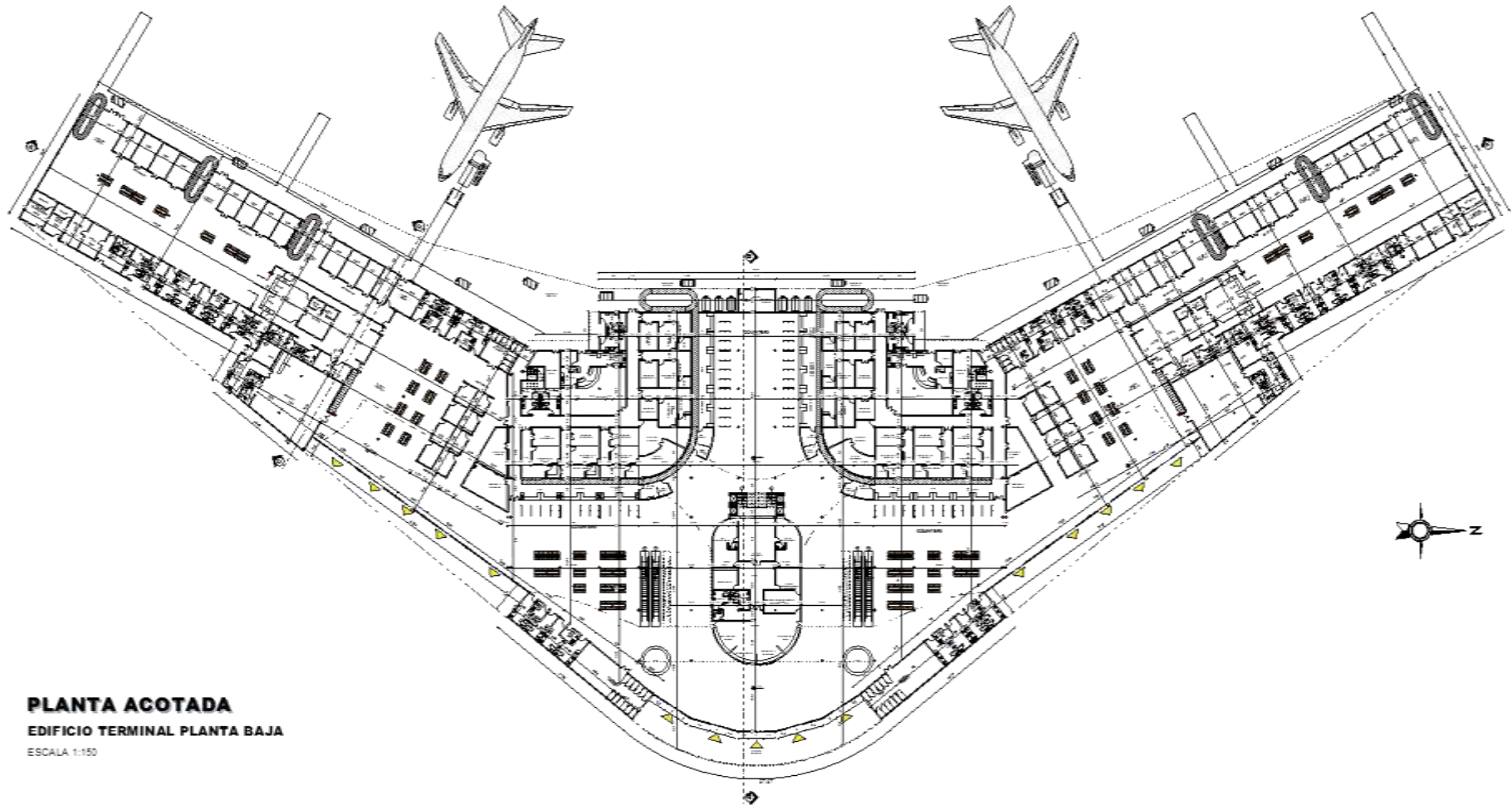

**PLANTA ACOTADA**  
**EDIFICIO TERMINAL PLANTA BAJA**  
ESCALA 1:100

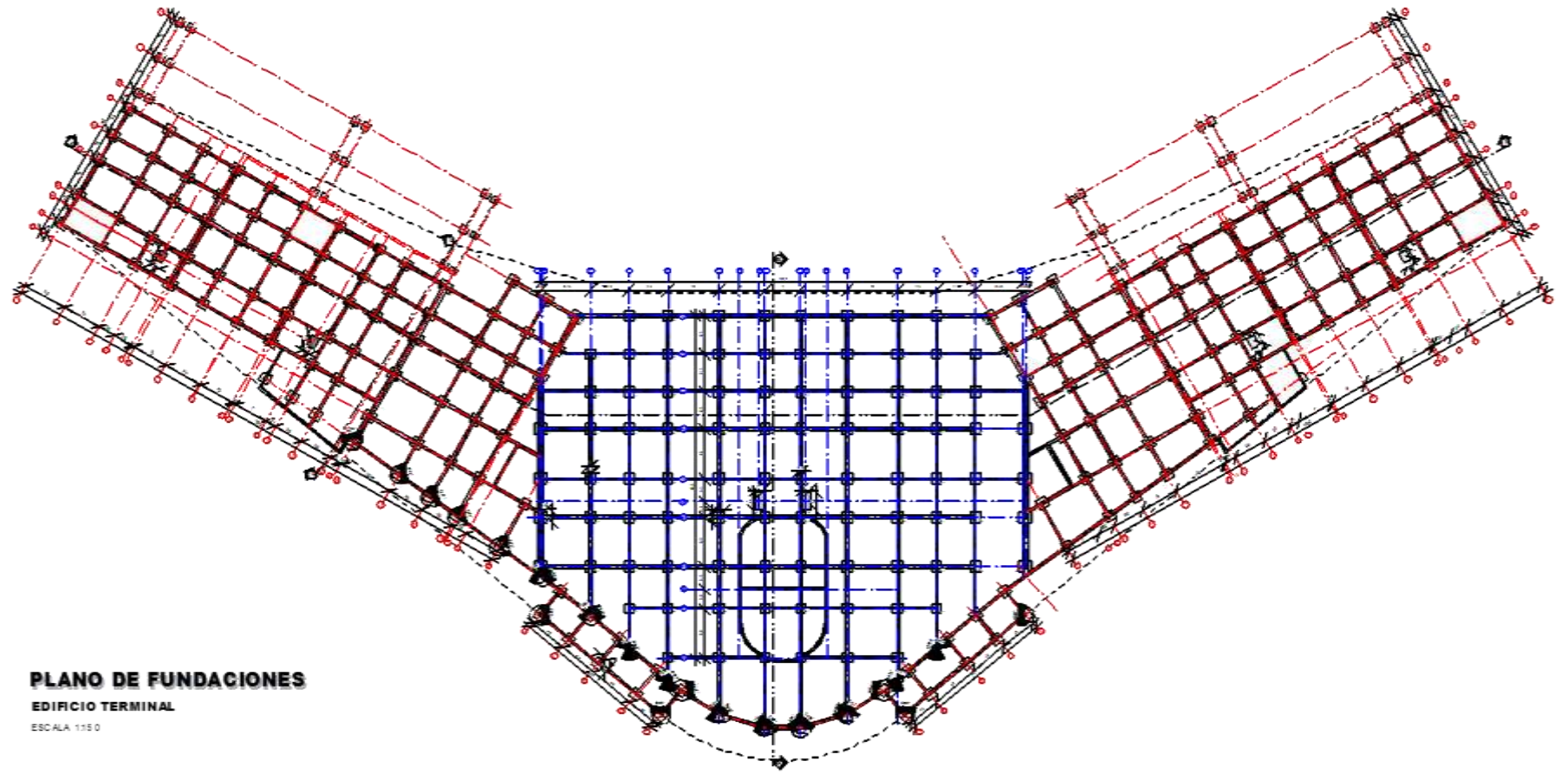

**PLANO DE FUNDACIONES**

**EDIFICIO TERMINAL**

ESCALA 1:150

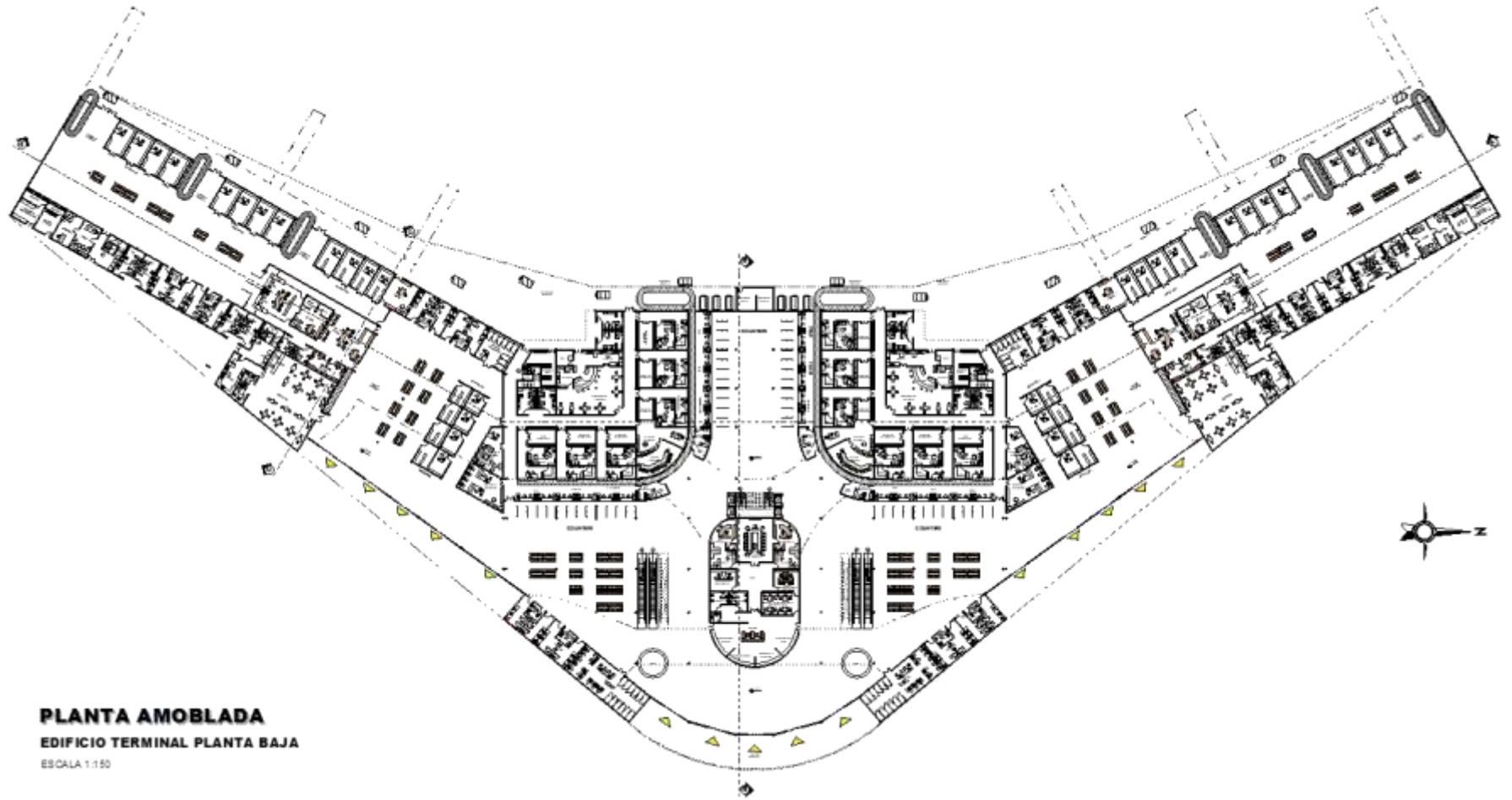

**PLANTA AMOBLADA**  
**EDIFICIO TERMINAL PLANTA BAJA**  
ESCALA 1:150

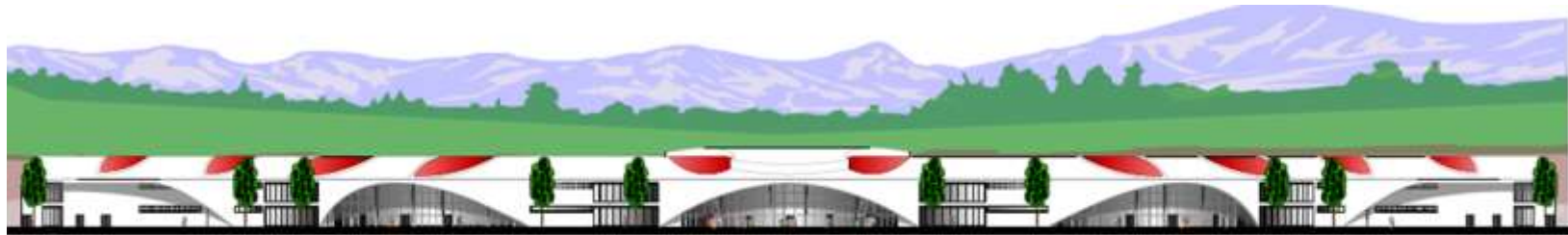

ELEVACION ESTE  
ESCALA 1:100



ELEVACION OESTE  
ESCALA 1:100



ELEVACION SUR  
ESCALA 1:100



**CORTE A - A'**  
ESCALA 1:200



**CORTE B - B'**  
ESCALA 1:100



**CORTE C - C'**  
ESCALA 1:100

PLANIMETRIA GENERAL DE CONJUNTO

